

WELCOME

Westside Creeks Ecosystem Restoration: **Alazán and Martinez Creeks** Interim Design Update



Presented by: US Army Corps of Engineers
San Antonio River Authority
Michael Baker Int'l – Huitt Zollars JV



**US Army Corps
of Engineers®**



**SAN ANTONIO
RIVER AUTHORITY**

Wednesday, October 9, 2024

Ways to Participate in the Design Process

- Follow project updates online at westsidecreeks.com
 - Presentations posted online in English and Spanish
 - Fill out online comment form
- Attend in-person Information Session
 - View presentation
 - Fill out comment card
 - View poster boards and ask questions
 - Posters and Experts available to answer questions
- Attend Westside Creeks Restoration Oversight Committee Meetings
 - Next: November 19, 2024
 - RA Boardroom 6 PM



Part 1: Project Background

Rebecca Krug, Sr. Project Manager



Overview

Federal project partnership with US Army Corps of Engineers to restore channelized Westside Creeks and improve community connectivity.

EXISTING CONDITIONS



RESTORATION MEASURES



Project Team

Federal Sponsor:

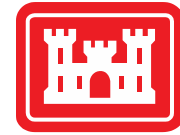

**US Army Corps
of Engineers®**

Non-Federal Sponsor:



Local Funding Partner:



Architect – Engineer:

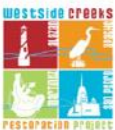

Background

- 2008 – Westside Creeks Restoration Oversight Committee formed
- 2012 – Vision Plan
- 2014 – Feasibility Study
- Jan 2022 – USACE Announces \$75 million funding for the project
- Sept 2022 – SARA/USACE Partnership
 - Pre-design Activities Begin: Survey and Baseline Environmental Studies
- March 2023 – Design Phase Begins
 - Architect-Engineer: Michael Baker Intl. – Huitt Zollars JV
- July 2023 – Public Input Session
 - Recreation Features
- September 2023 – 35% Initial Design Milestone
- October 2024 – 65% Interim Design Milestone



Project Area

- **San Pedro Creek**
 - Project 2.4 Miles
- **Apache Creek**
 - Project Length = 2.6 miles
- **Alazán Creek**
 - Project Length = 4.0 Miles
- **Martinez Creek**
 - Project Length = 2.4 miles

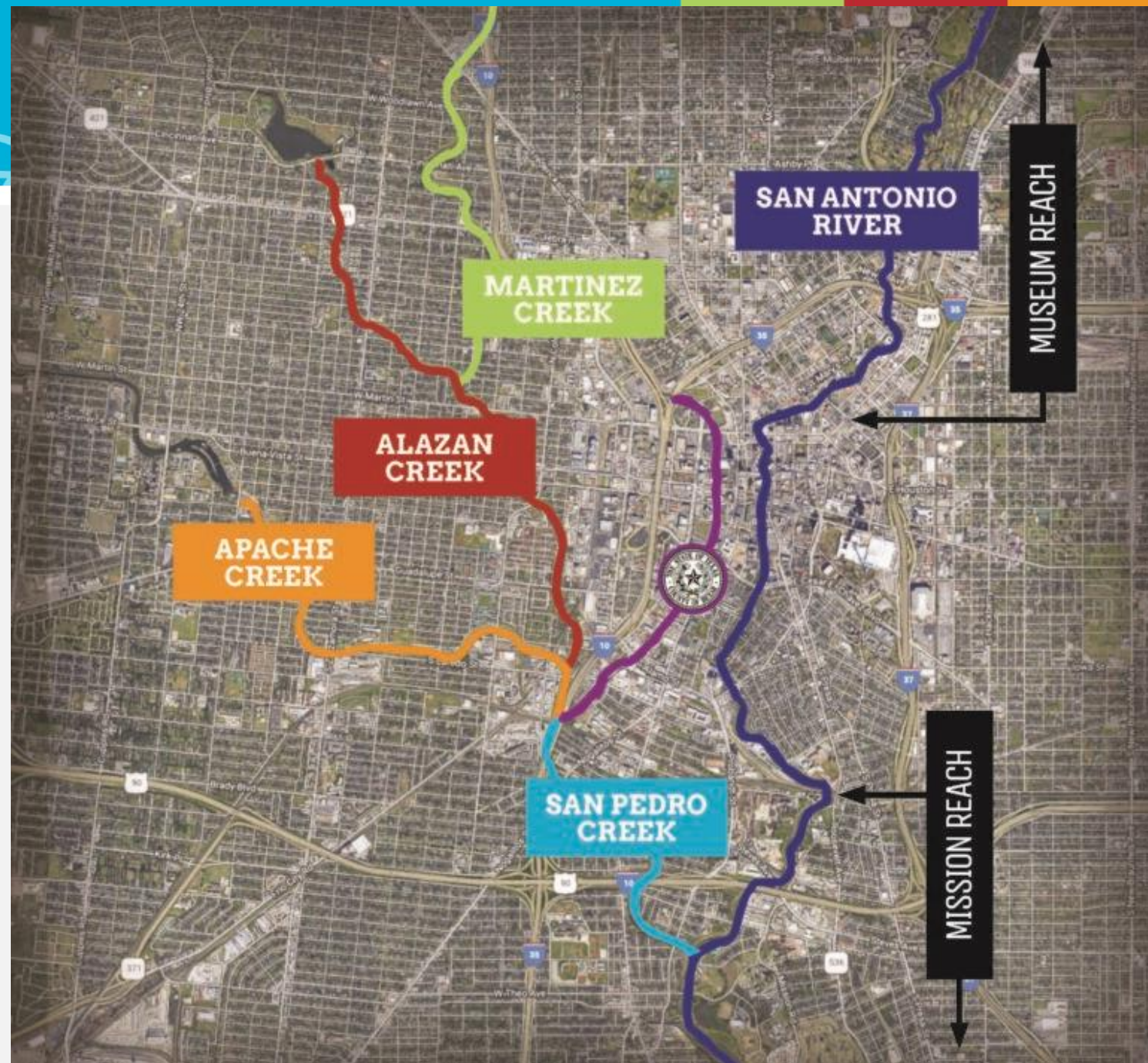

Oversight Committee Organizations

Alazán Resident Council
Avenida Guadalupe
Beacon Hill Neighborhood Association
Bexar Audubon Society
Historic Westside Residents Association
Los Bexareños Genealogical Society
Martinez Creek Neighborhood Association
Opportunity Home San Antonio
Our Lady of the Lake University
Prosper West
Prospect Hill Neighborhood Association

River Aid San Antonio
San Antonio Alternative Housing Corporation
San Antonio Conservation Society
San Antonio Independent School District
San Antonio Wheelmen
St. Mary's University
Student At-Large
TexasTejano.com
University of Texas at San Antonio
United San Antonio Pow Wow Inc.
Woodlawn Lake Neighborhood Association

*The River Authority Board appointments committee organizations, the organizations select their member representatives



Part 2: Design Concept Overview

Danny Allen, Wildlife Biologist
Jeff Holba, Landscape Architect



US Army Corps
of Engineers®



Design Overview

Martinez Creek

- 44 acres of Riparian Meadow
- 2.4 miles of existing creek channel

Alazán Creek

- 6.3 acres of Riparian Woody
- 46.6 acres of Riparian Meadow
- 3.3 miles of pilot channel
- 86 pool-riffle complexes
- 52 slackwater areas

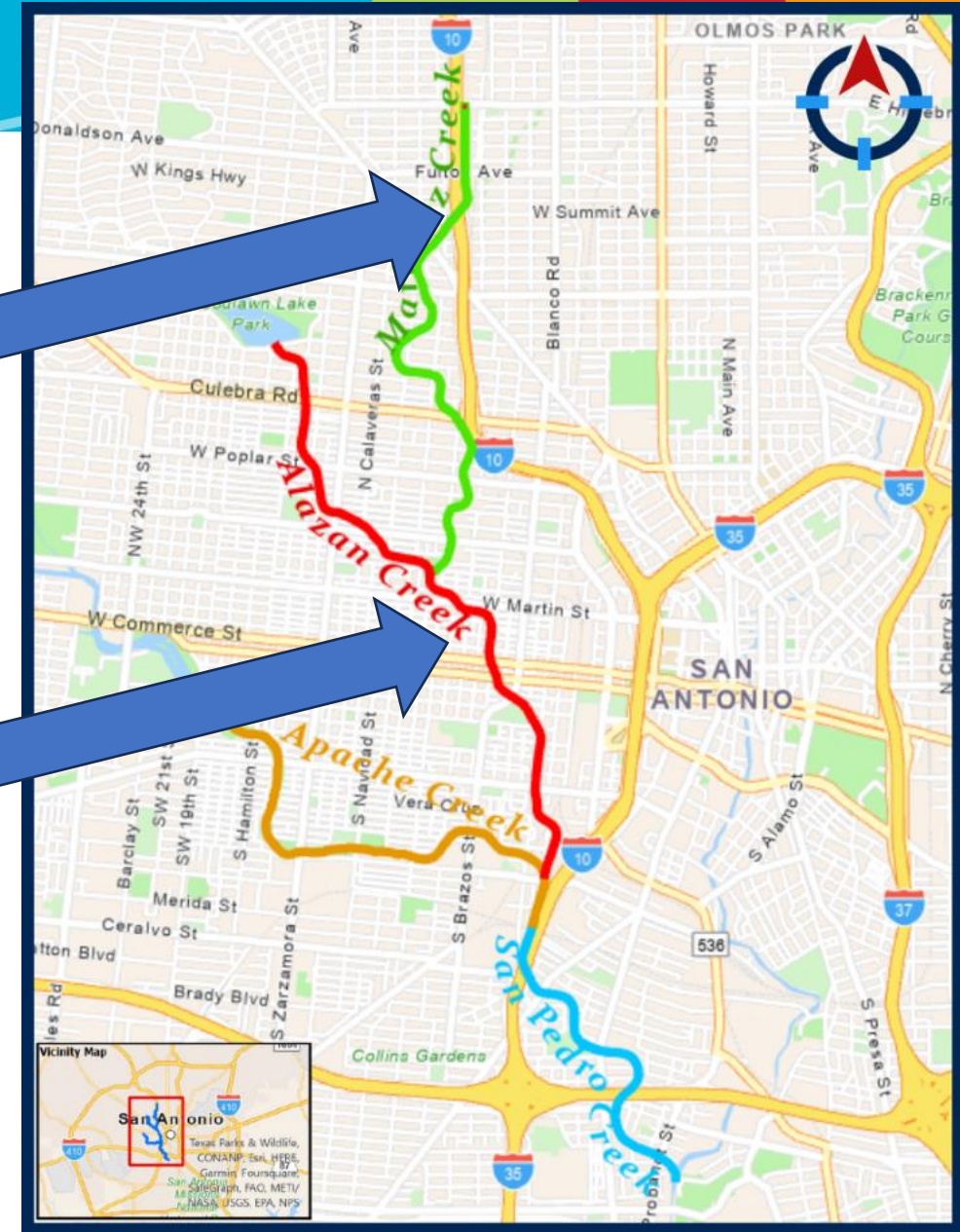

*Proposed design elements are subject to change

Alazán Creek Design Considerations

- 1 railroad crossing
- 4 low water crossings
- 2 pedestrian bridge crossings
- 17 street bridge crossings
- ~ 15 underground utilities



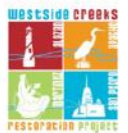

*Proposed design elements are subject to change

Proposed Alazán Creek Cross Vane

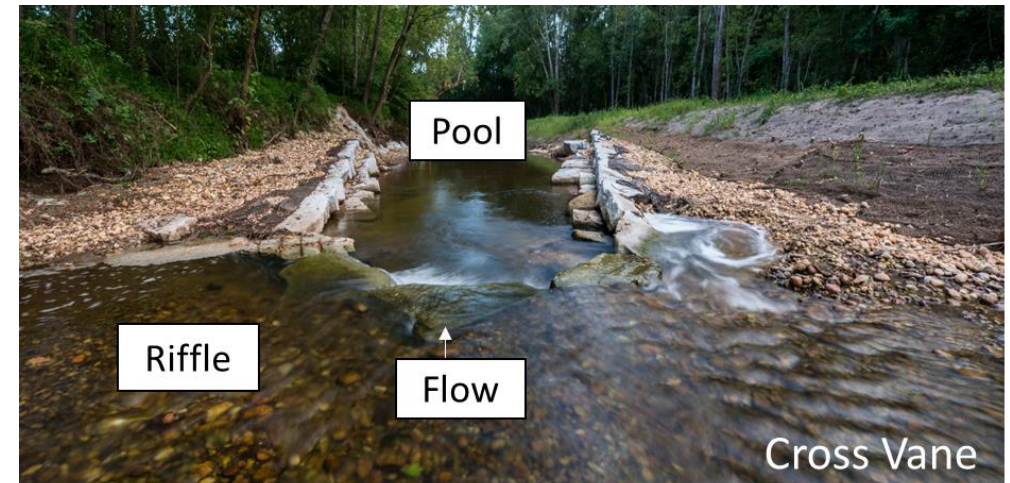
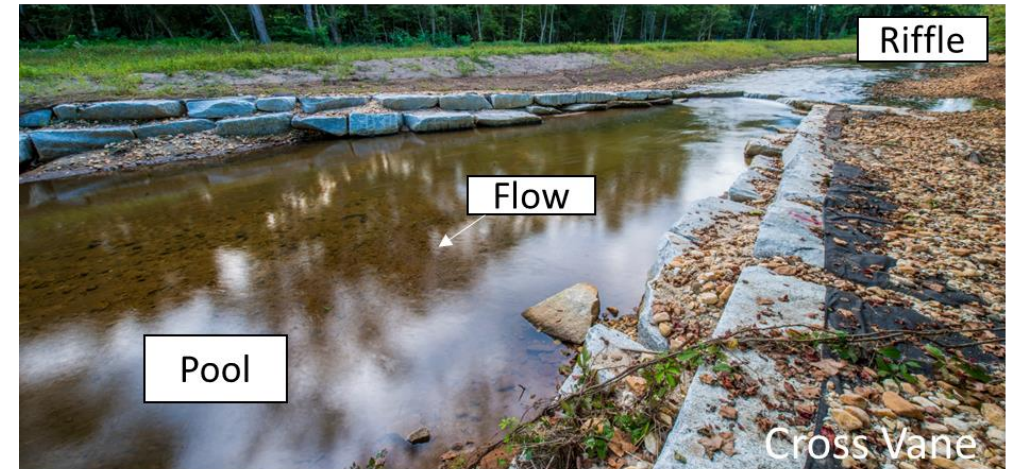
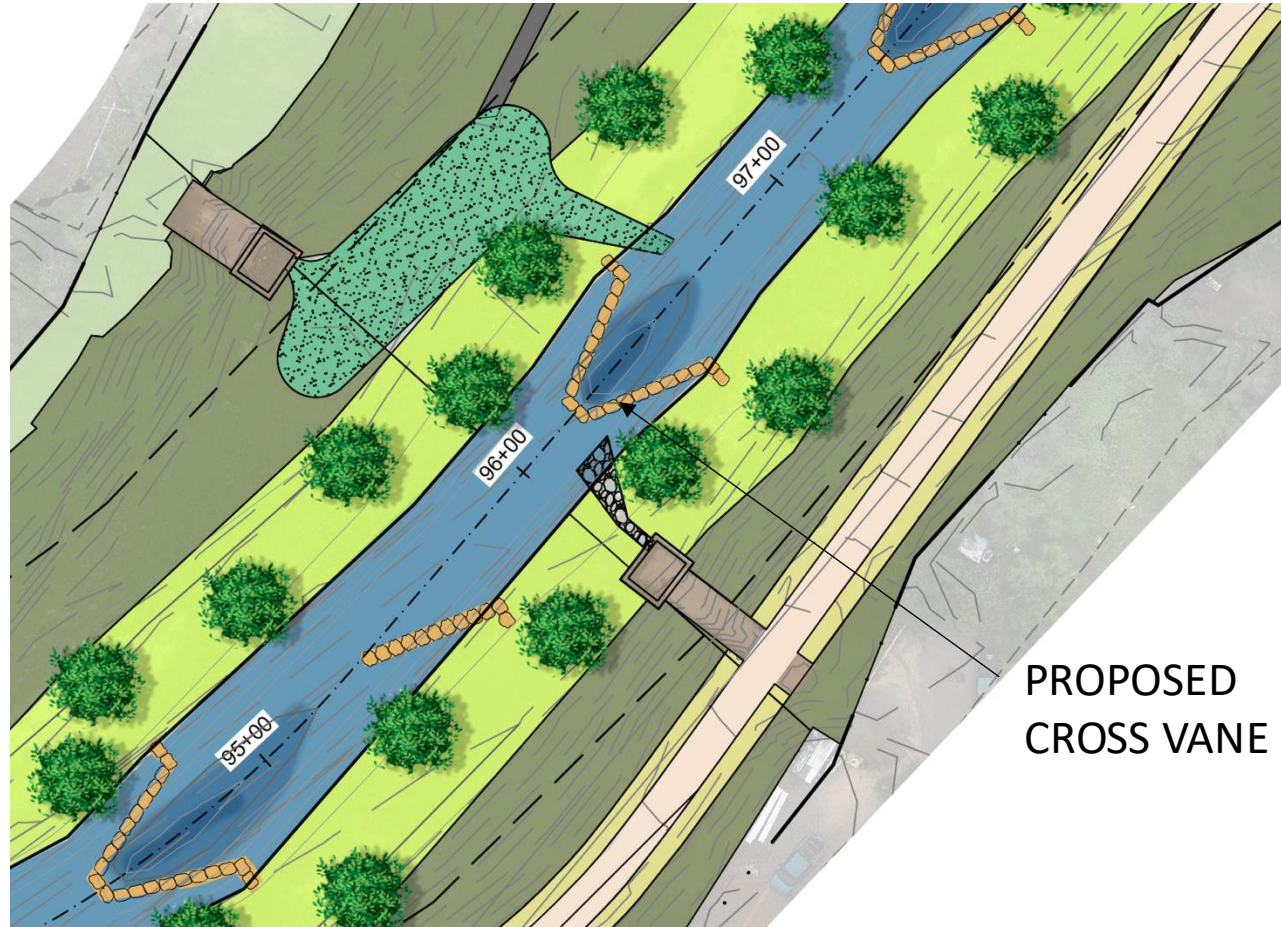

Proposed Alazán Creek Slackwater

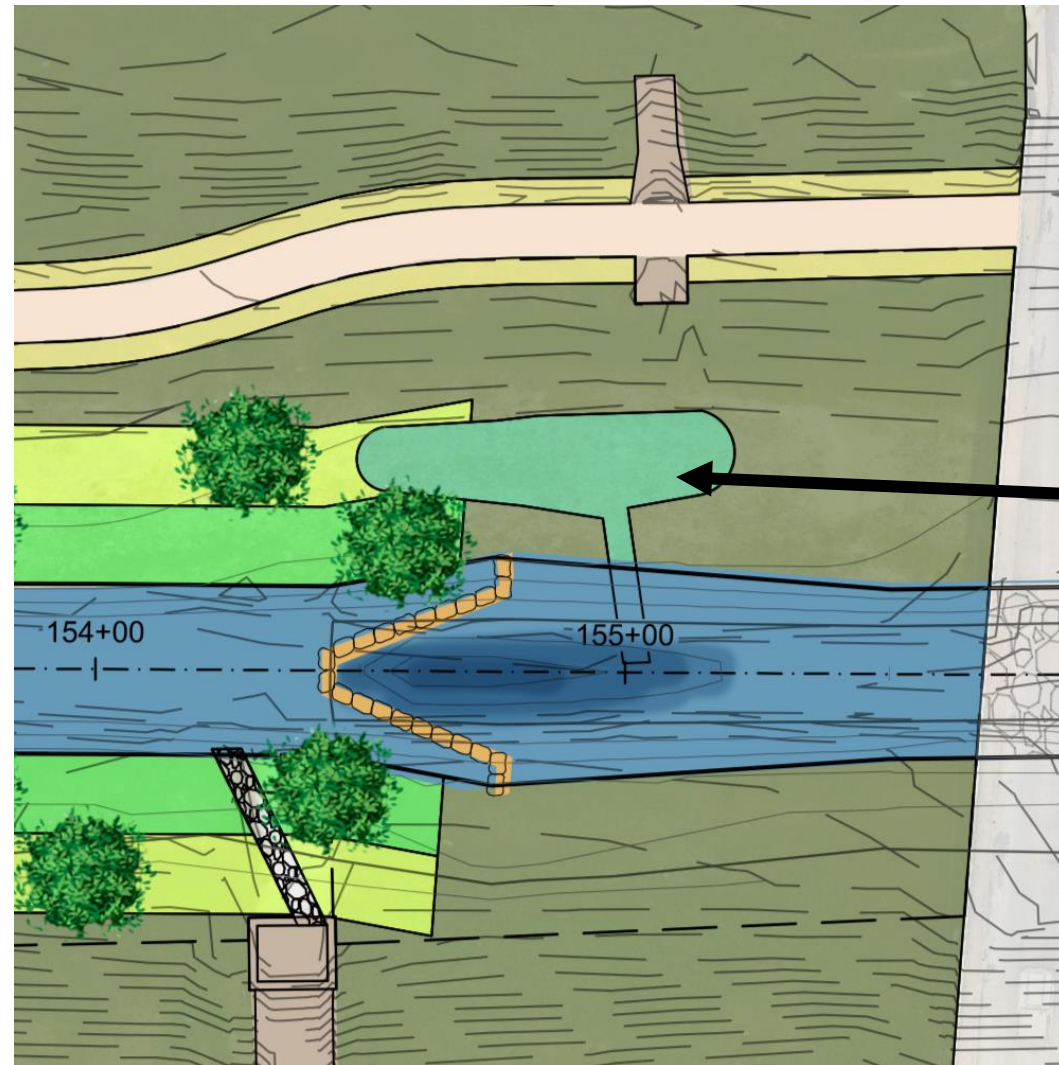

PROPOSED
SLACKWATER



SLACKWATER

*Proposed design elements are subject to change

Proposed Alazán Creek Geolift/ J Hook vane

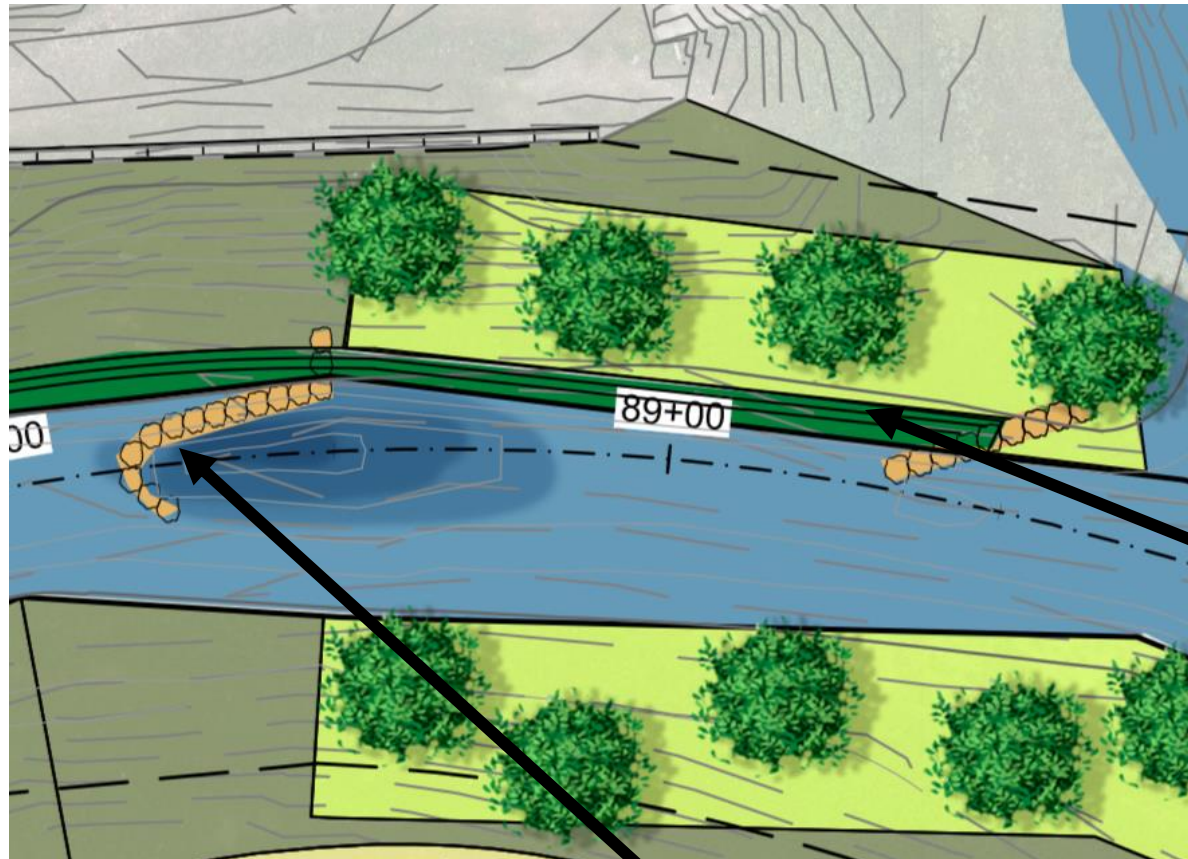

PROPOSED
J HOOK

PROPOSED
GEOLIFT



GEOLIFT



J HOOK

*Proposed design elements are subject to change

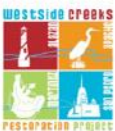

*Proposed design elements are subject to change

Proposed Alazán Creek Planting- Riparian Woody

At some locations along edge of creek

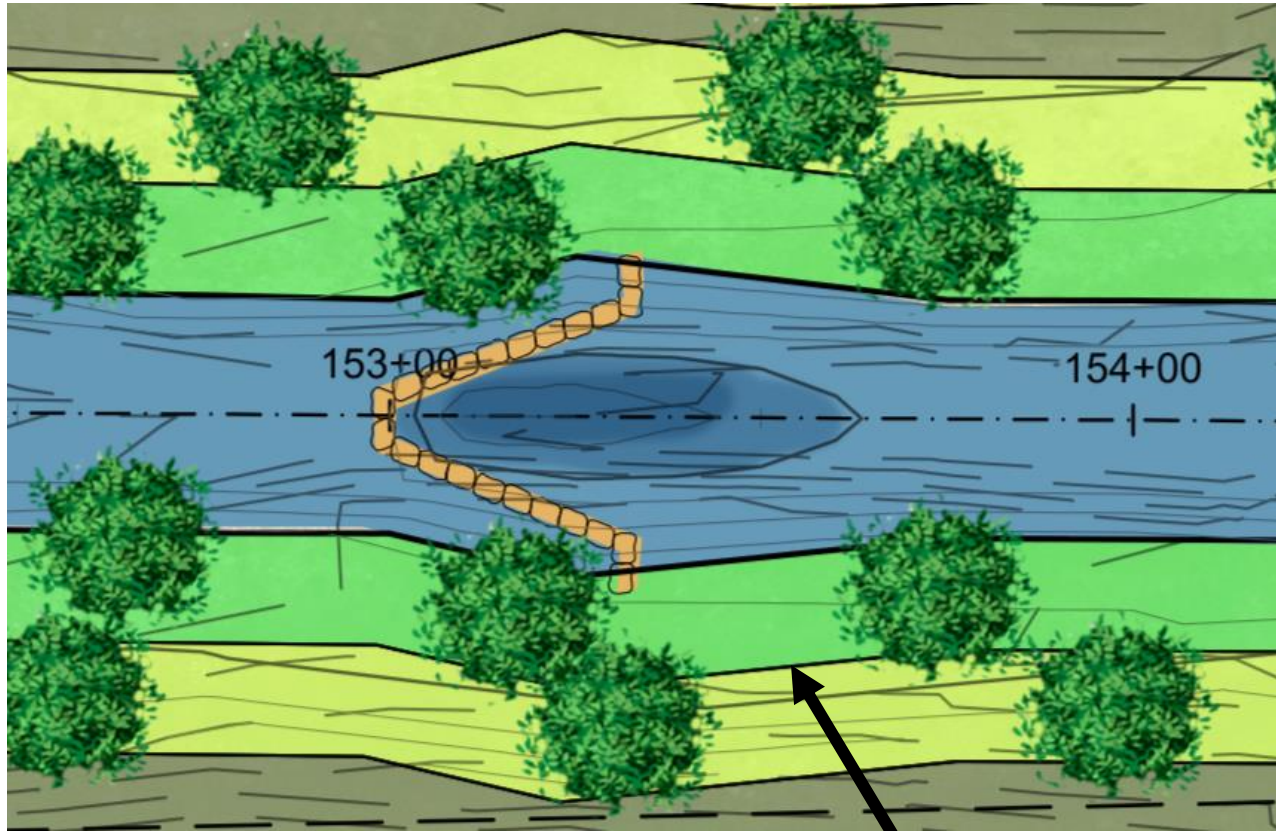

PROPOSED RIPARIAN
WOODY



RIPARIAN WOODY

*Proposed design elements are subject to change

Proposed Alazán Creek Planting- Native Tall Grass

At some locations along top of creek bank



PROPOSED NATIVE
TALL GRASS MIX



NATIVE TALL GRASS MIX

Proposed Alazán Creek Planting- Native Short Grass

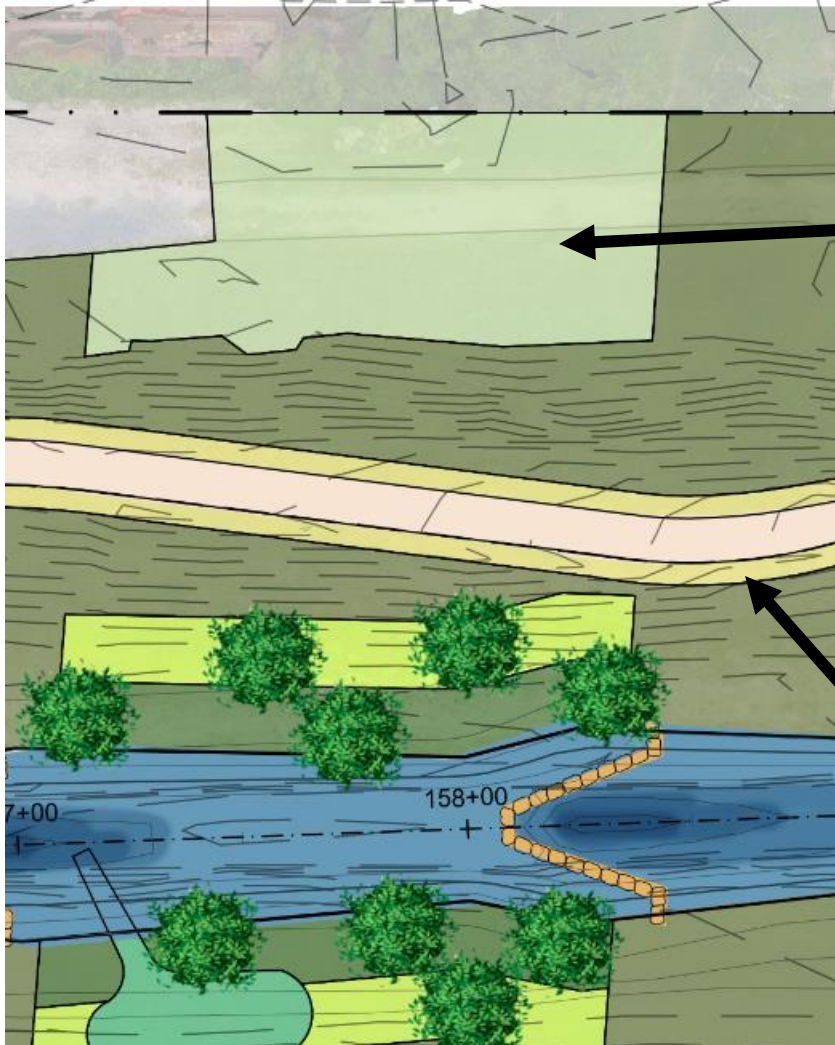

PROPOSED
NATIVE SHORT
GRASS MIX

PROPOSED
MOWSTRIP



PROPOSED NATIVE SHORT GRASS MIX



MOWSTRIP

*Proposed design elements are subject to change

Typical Alazán Creek Sections

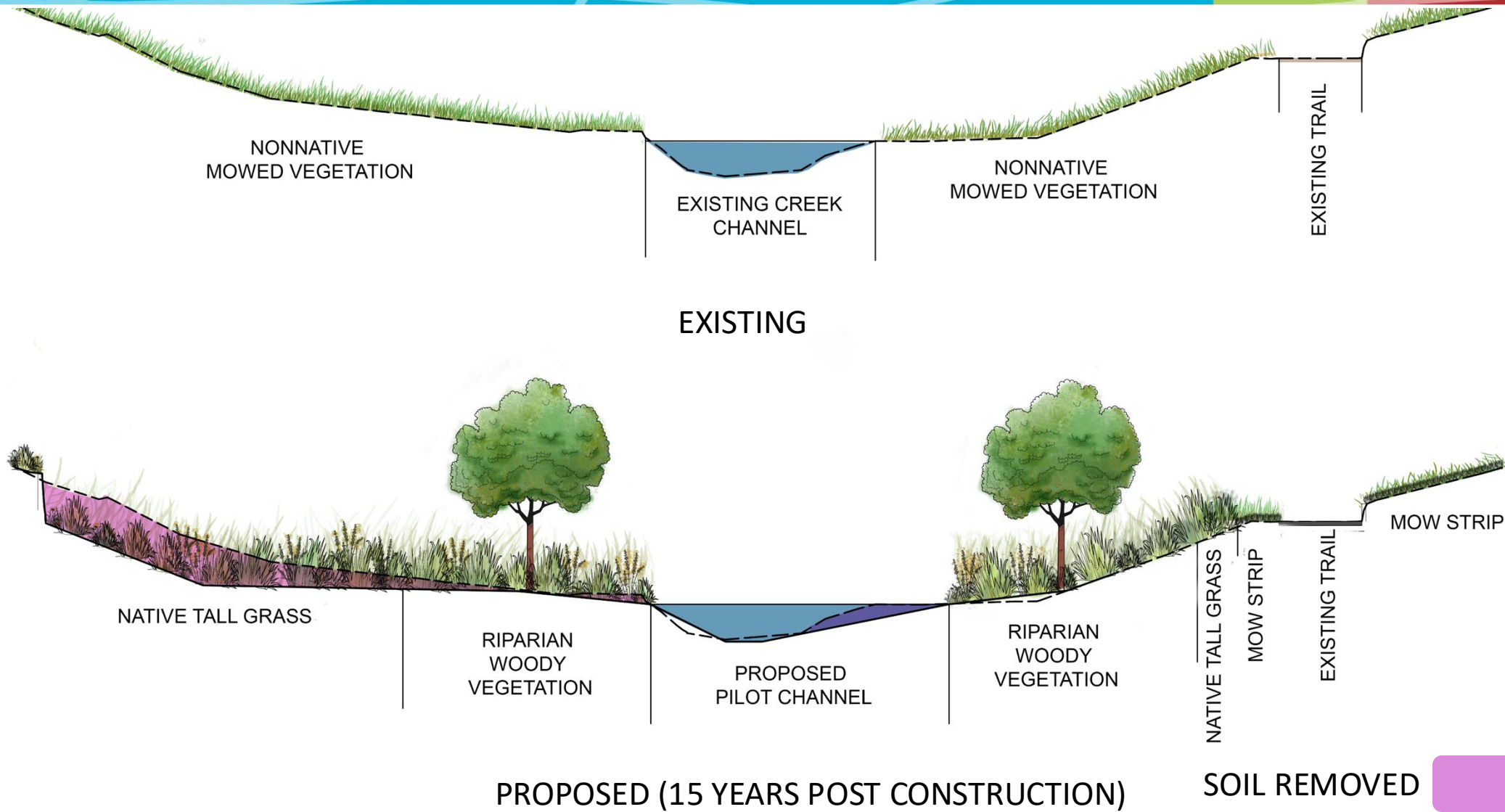

*Proposed design elements are subject to change

Typical Alazán Creek Sections

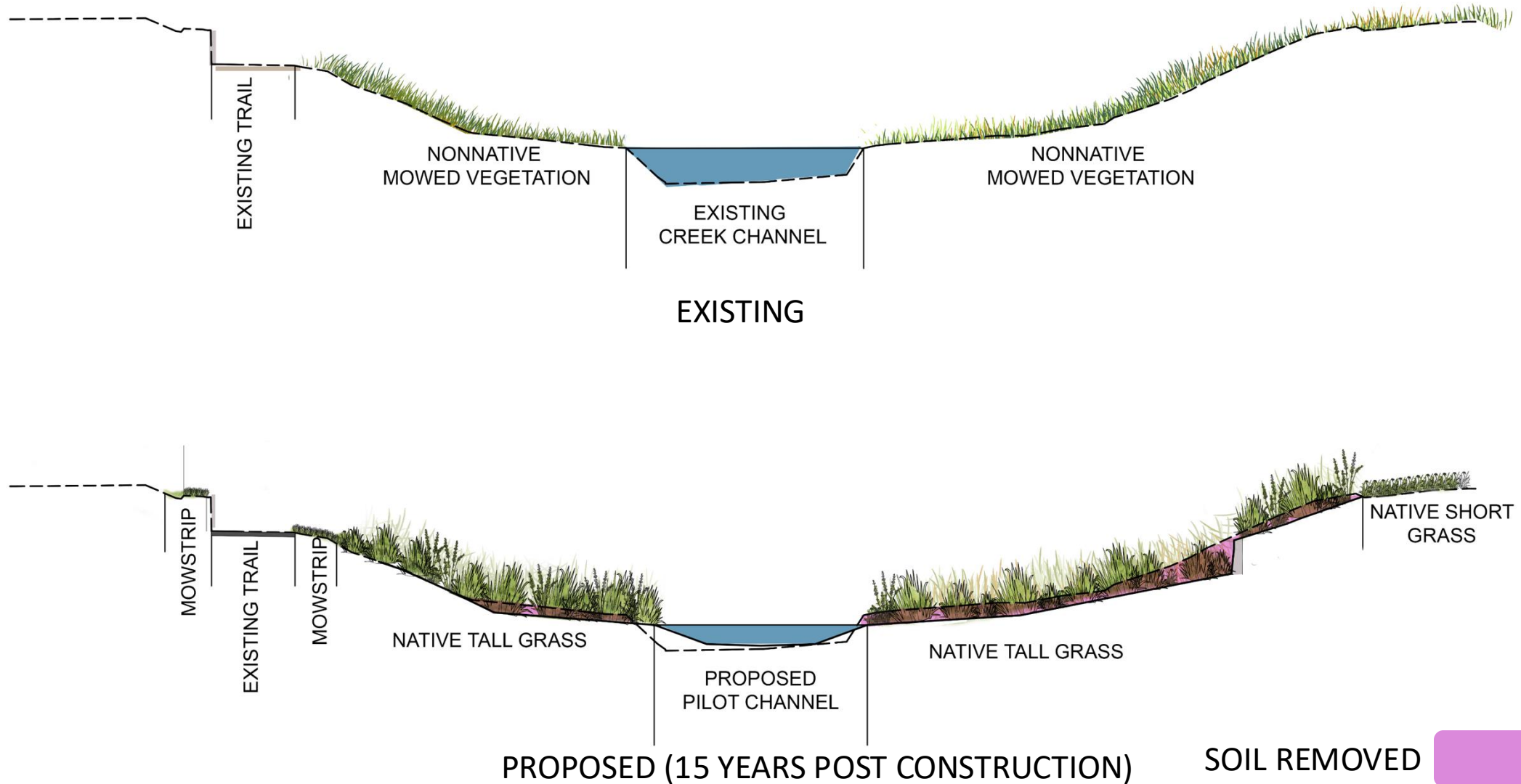

*Proposed design elements are subject to change

Alazán Creek Today



Alazán Creek Proposed



Martinez Creek Design Considerations



- 2 pedestrian bridge crossings
- 1 interstate crossing
- 10 street bridge crossings
- Reinforced concrete banks
- Underground utilities

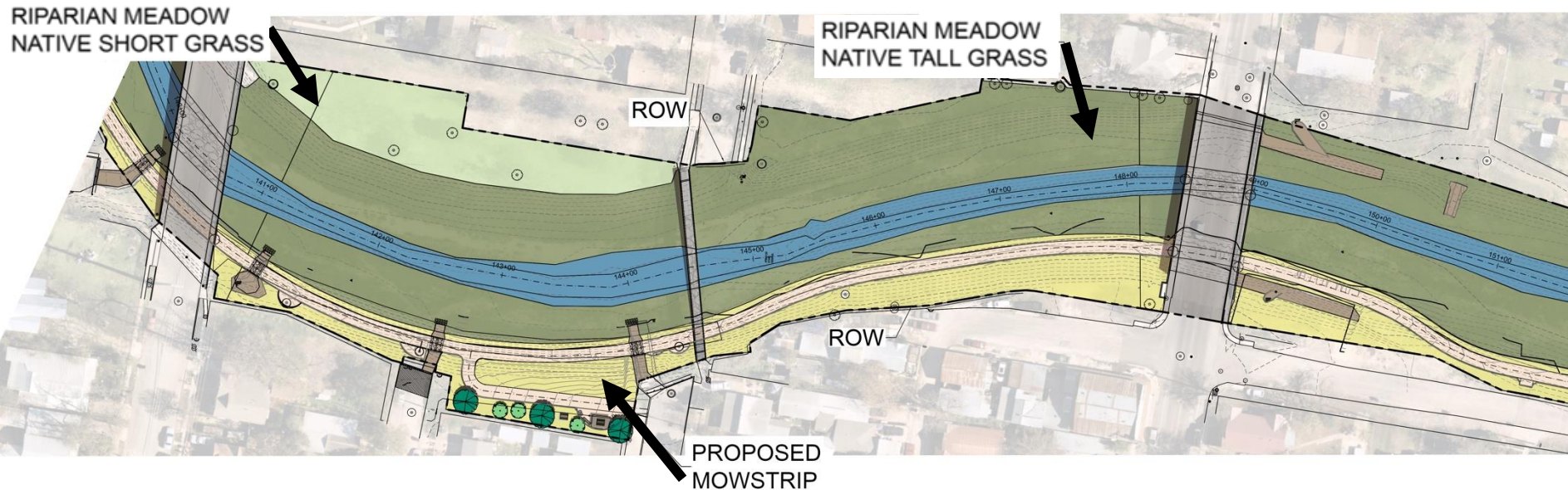

Proposed Martinez Creek Planting



LEGEND

-  RIPARIAN MEADOW NATIVE TALL GRASS
-  RIPARIAN MEADOW NATIVE SHORT GRASS
-  5' MOW STRIP



NATIVE SHORT GRASS MIX



NATIVE TALL GRASS MIX



MOWSTRIP

*Proposed design elements are subject to change

Proposed Martinez Creek Trail Extension

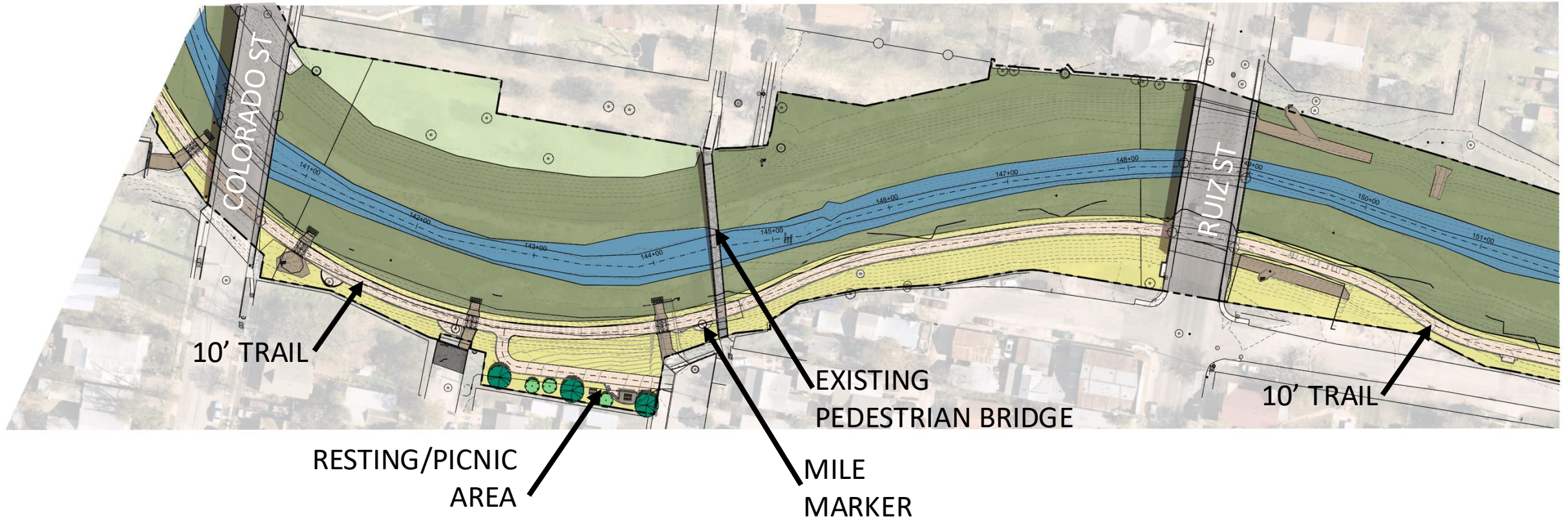

*Proposed design elements are subject to change

Proposed Martinez Trail Picnic/Rest Areas

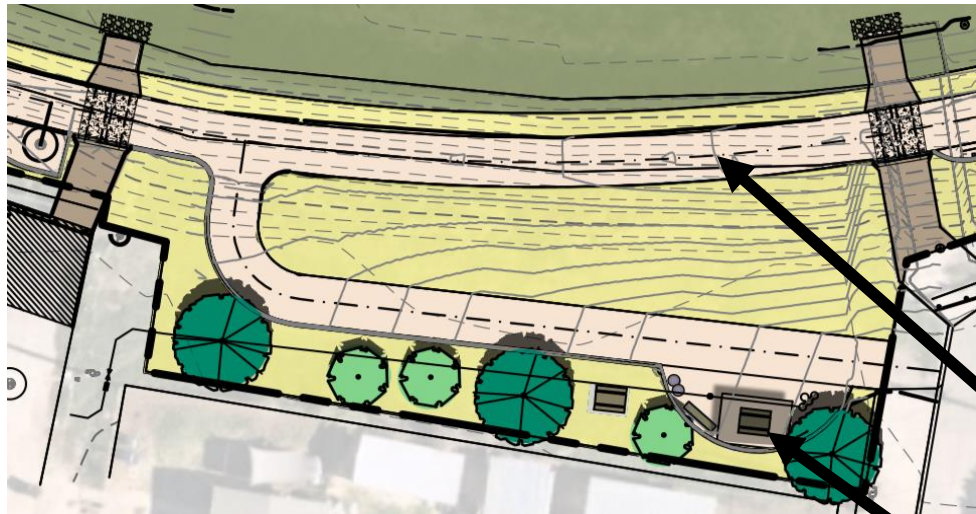

PROPOSED
TRAIL

PROPOSED
PICNIC/REST
AREA



*Proposed design elements are subject to change

Typical Martinez Creek Sections

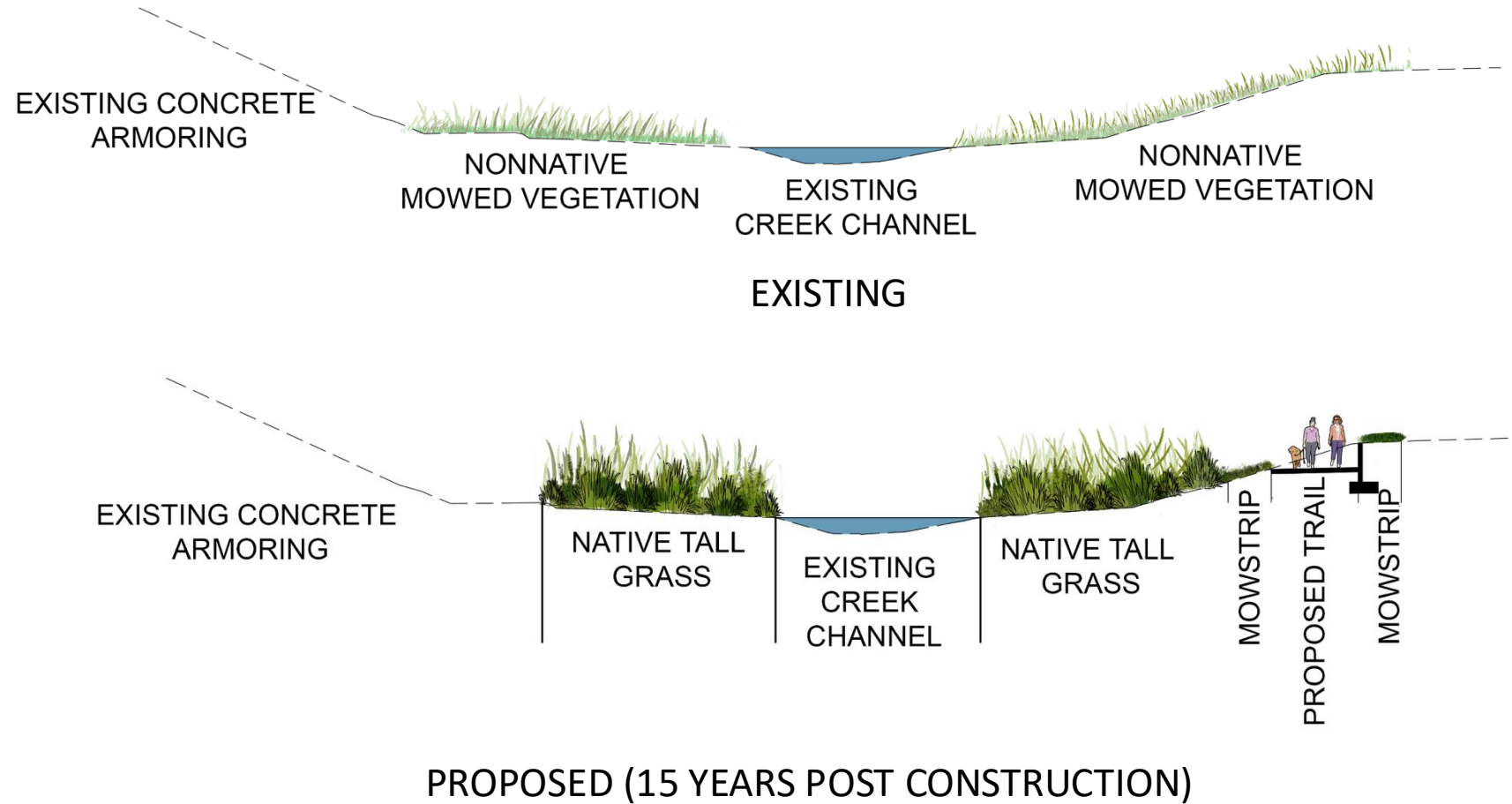

*Proposed design elements are subject to change

Typical Martinez Creek Sections

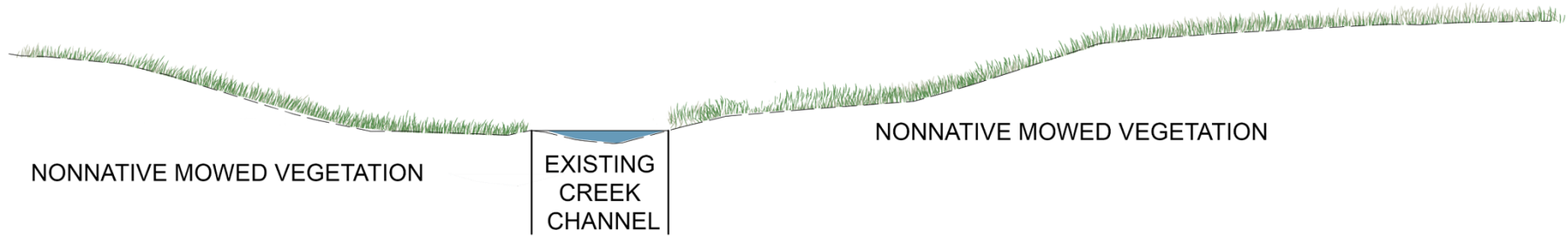

EXISTING

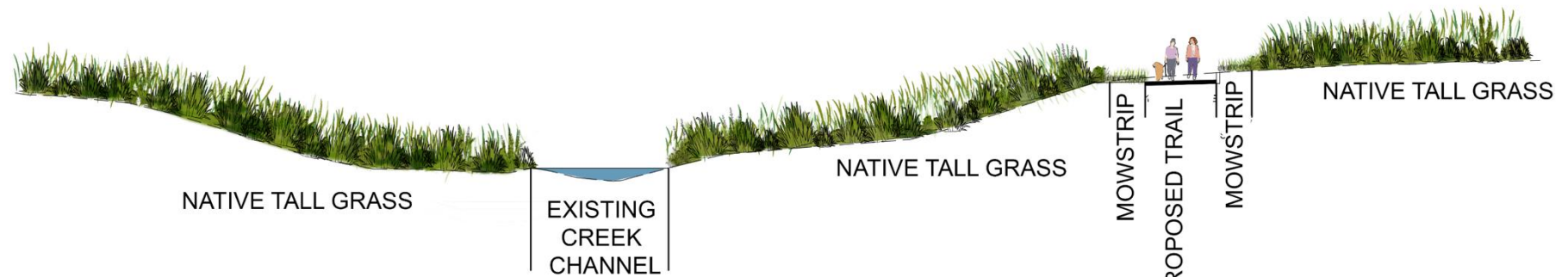

PROPOSED (15 YEARS POST CONSTRUCTION)

*Proposed design elements are subject to change

Martinez Creek Today



Martinez Creek Proposed



Vegetation Value

Food for wildlife:

Nectar, foliage, pollen, seeds, nuts, fruits, etc.



Shelter for wildlife

Vegetation Value



Soil and creek bank
stabilization

Shading

Filtration for water
quality

Higher tolerance of heat,
drought, and flooding



Vegetation Growth Over Time



Recreation Amenities

- Interpretive and wayfinding signs
- Shade structures
- Benches
- Water fountains
- Picnic tables
- Trash receptacles



*Proposed designs are subject to change

Proposed Amenity Layout: Picnic Area

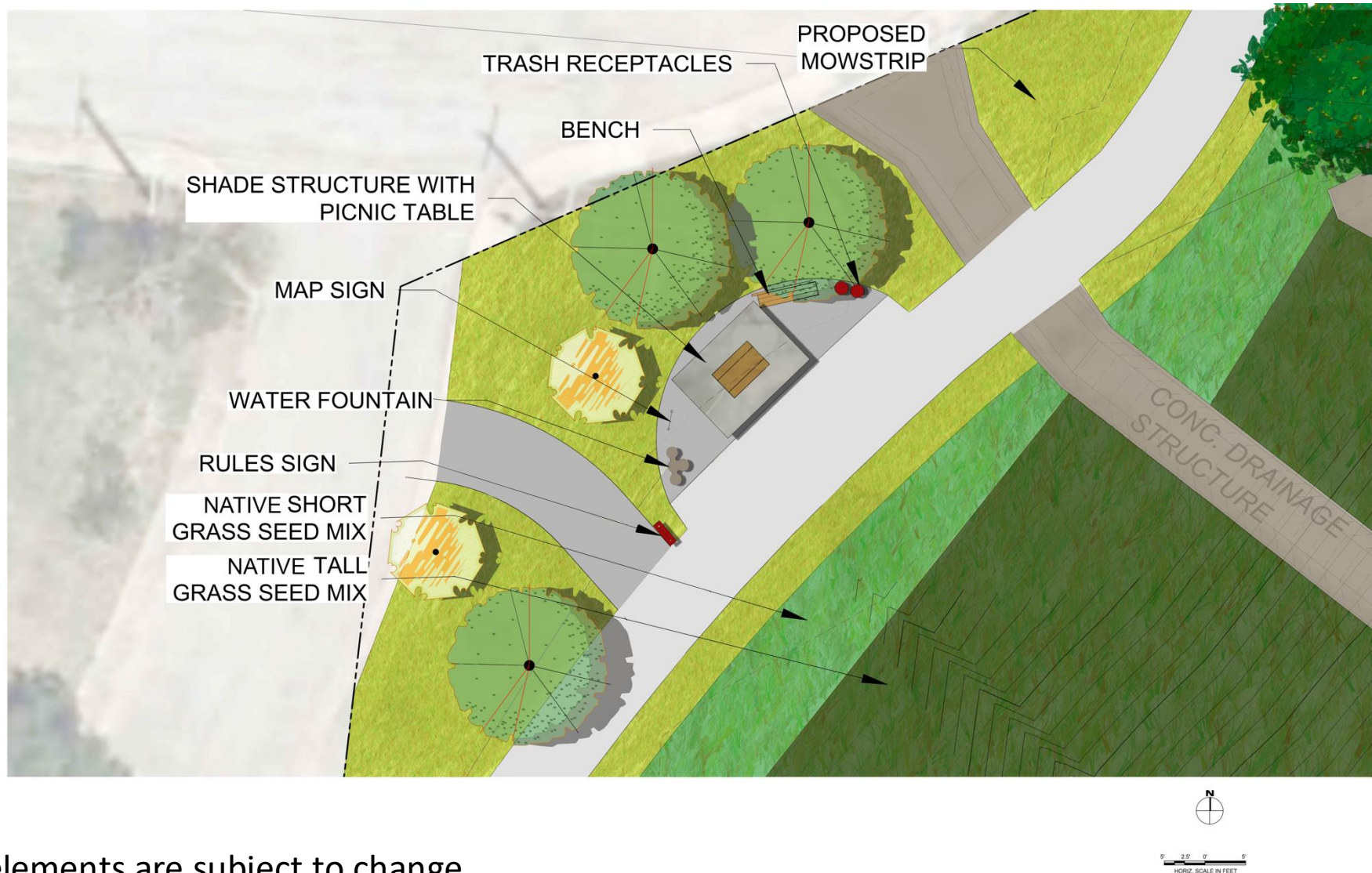

*Proposed design elements are subject to change

Proposed Amenity Layout: Rest Area

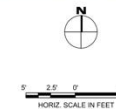

*Proposed design elements are subject to change

Future Opportunities

- Trailheads
- Scenic Overlook

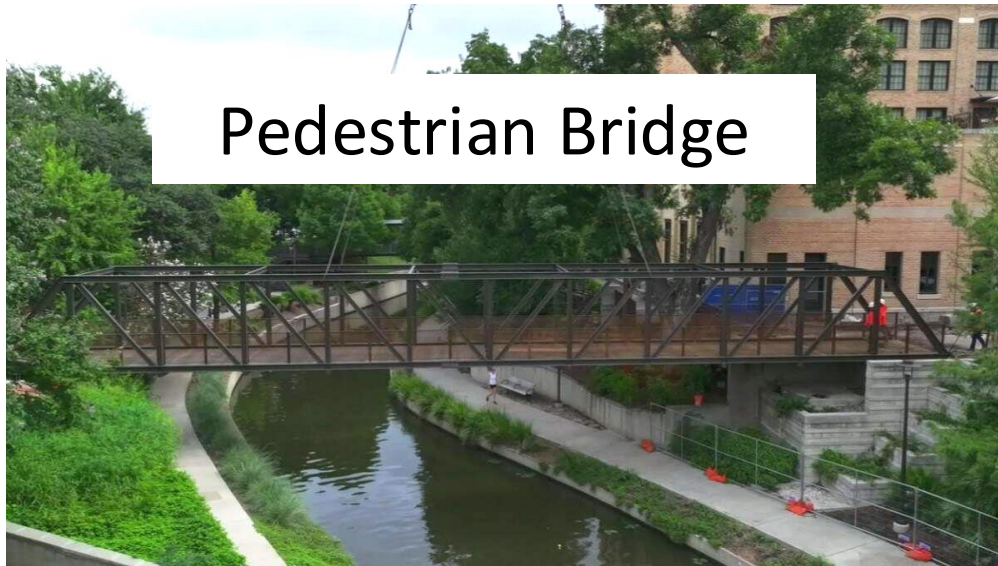

*Proposed designs are subject to change

Part 3: Look Ahead

Zia Burns, Program Manager

Andrew Park, Program Manager

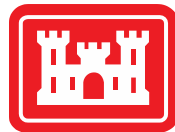

**US Army Corps
of Engineers®**

Proposed Schedule*

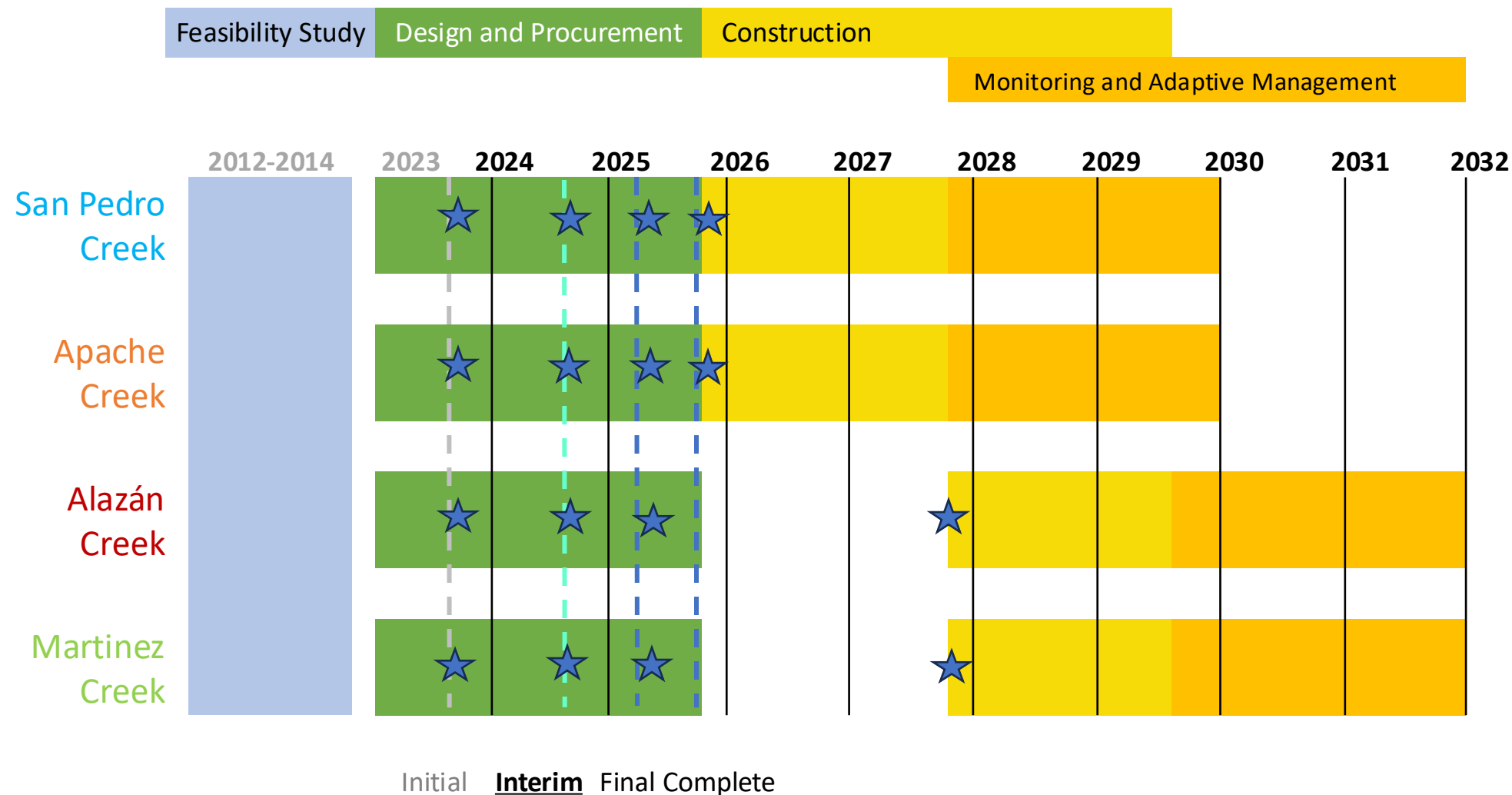

*Proposed schedule subject to change

★ Public Engagement



NEPA Overview and Partnerships

Cultural

- Surveys (Architectural and Archeological) of base area completed
- Inclusive consulting with 16 parties
- Draft report expected in Fall of 2024
- Additional survey and analysis will be required with betterments

Environmental

- Continue coordination with stakeholders and application of federal, state, and local regulations.

Ways to Participate in the Design Process

- Follow project updates online at westsidecreeks.com
 - Presentations posted online in English and Spanish
 - Fill out online comment form
- Attend in-person Information Session
 - View presentation
 - Fill out comment card
 - View poster boards and ask questions
 - Posters and Experts available to answer questions
- Attend Westside Creeks Restoration Oversight Committee Meetings
 - Next: November 19, 2024
 - RA Boardroom 6 PM



Upcoming Open House – Tomorrow Night

You're invited:

Open House - All Creeks

Thursday, 10/10

2-5 PM

Bazan Library, 2200 W. Commerce St.



Thank you!

Please join us at the poster boards

Refreshments provided

Contact Information



**US Army Corps
of Engineers®**

US Army Corps of Engineers
Public Affairs Office

Phone number: 817-886-1306
westsidecreeks@usace.army.mil

CESWF-PA

819 Taylor Street Suite 3A24
Fort Worth TX 76102



River Authority
Public Outreach

westsidecreeks@sariverauthority.org