

# Westside Creeks

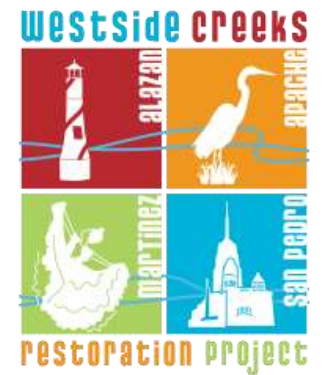

City of San Antonio



## Elmendorf Lake Park and Linear Creekway Trails Project

August 11, 2015



# Elmendorf Lake Park Project

## Project Partners

- City of San Antonio
- Bexar County
- Our Lady of the Lake University
- San Antonio River Authority
- Local Community

## Goal

- To build on input received through the Westside Creeks Restoration Concept Plan, Westside Summits and public workshops to develop a “Great People Place in the Westside.”



# Elmendorf Lake Park Project

## Project Funding Sources

- \$2,250,000 in Parks, Recreation and Open Space – COSA 2012 Bond Funding
  - \$1,500,000 in Drainage & Flood Control – COSA 2012 Bond Funding
  - \$1,500,000 in Stormwater Regional Facilities Funds – COSA
  - \$2,000,000 in Linear Creekway Funds – COSA 2010 Sales Tax Proposition
  - \$7,000,000 in Bexar County Flood Control Funds
- 
- \$14,250,000 in Total funding for Elmendorf Lake Park<sup>1</sup>

<sup>1</sup> Includes design, construction, and management



# Elmendorf Lake Park Project

- **Design:**
  - January 2013 – September 2014
- **Construction**
  - April 2015 – June 2016
- **Public Meetings**
  - Charrette No. 1 – 3/9/13
  - Public Meeting – 4/2/13
  - Charrette No. 2 – 4/16/15
  - Charrette No. 3 – 5/13/13
  - Open House 10/4/2014
- **Designer**
  - Terra Design Group
    - Arcadis
- **Contractors**
  - Jerdon (Bridge and Island)
  - MAC, Inc (South)
  - Journeyman (North)



# Elmendorf Lake Park Project

## Project Components

- Parking Lot Porous Paving
- Interpretive Signs
- Wetlands
- Bioswales / Rain Gardens
- Expanded Parking (63 additional spaces)
- Three Pedestrian Channel Crossings
- 4,100 Feet Of Trail
- Expanded VIA Bus Stop
- 22nd / Commerce St. Pedestrian Crossing
- Multiple Trail Nodes At Lakes Edge
- Main Plaza With Electrical Grid
- Improved And Expanded Lighting



# Elmendorf Lake Park Project



# Cantilevered Piers

- Experience Off Water
- Picnic Tables
- Interpretive Signage



# Picnic Plaza

- Lighted
- Overlook Lake



# Bioswales / Rain Garden

Low Frequency Detention

First Flush Treatment of Pollutants



# Wetland Feature

Intercepts Water from Street

Re-circulates Lake Water

Reduces Phosphorous and Nitrogen



City of San Antonio



SAN ANTONIO  
RIVER AUTHORITY  
Leaders in Watershed Solutions



Watershed Ebooks  
PROFESSIONAL PROGRAM



## Lake Access

Unique vantage points

Interpretive Signage



## Wayfinding Signage



City of San Antonio



SAN ANTONIO  
RIVER AUTHORITY  
Leaders in Watershed Solutions



Malcolm Pirnie | Arcadis  
The Water Division of Arcadis



Watershed Ebooks  
Professional Program



**Lake Plaza**  
Colorful and Distinctive  
Seating  
Recognizable Theme Reflecting  
Community Culture



City of San Antonio



SAN ANTONIO  
RIVER AUTHORITY  
Leaders in Watershed Solutions



The Water Division of ARCADIS



PROFESSIONAL PROJECT



## Connectivity

3 Pedestrian Bridges

Single Span 200'

Single Span 175'

Single Span 155'

Final Bridge Color

Polymer Blue Accent

with Graphite Structure

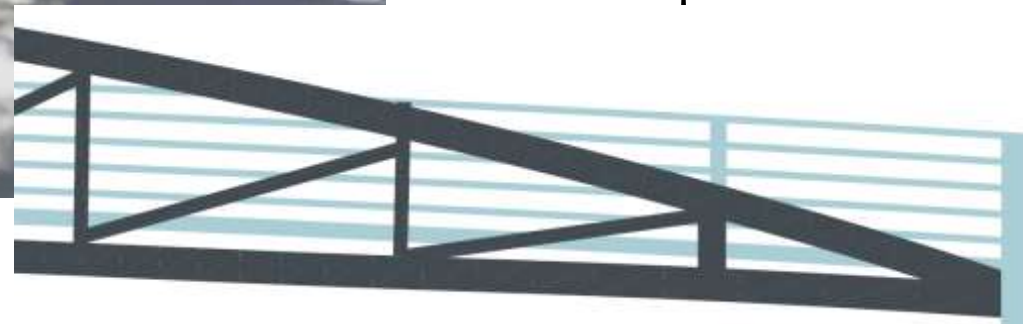

City of San Antonio



SAN ANTONIO  
RIVER AUTHORITY  
Leaders in Watershed Solutions



ARCADIS

The Water Division of ARCADIS



PROFESSIONAL PROJECT

# Elmendorf Lake Park Project



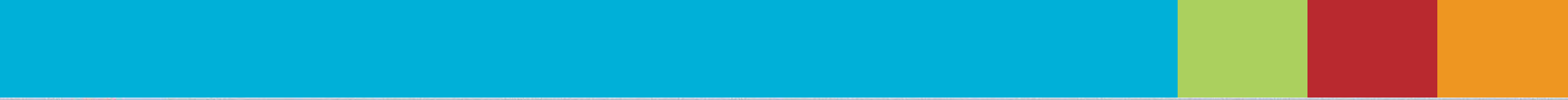

# ELMENDORF LAKE PARK



CITY OF SAN ANTONIO

# Status Report

- Elmendorf Lake Park (Estimated Completion)
  - Jerdon – Bridge Project (12/2015)
  - MAC, Inc – South Project (01/2016)
  - Journeyman – North Project (06/2016)
  - Project Progress Page
    - <http://www.westsidecreeks.com/elmendorflakeimprovementsprogress/>



# Status Report

## Elmendorf Island



City of San Antonio



SAN ANTONIO  
RIVER AUTHORITY  
Leaders in Watershed Solutions



The Water Division of ARCADIS





# Status Report

## Elmendorf Island



City of San Antonio



SAN ANTONIO  
RIVER AUTHORITY  
Leaders in Watershed Solutions



The Water Division of ARCADIS



# Status Report

## Elmendorf Island



# Status Report

## Elmendorf Bridge



City of San Antonio



SAN ANTONIO  
RIVER AUTHORITY  
Leaders in Watershed Solutions



# Status Report

## Elmendorf Bridge

Final Bridge Color Polymer Blue  
Accent with Graphite Structure



# Status Report

## Elmendorf South

- 24th Street Looking West



## Elmendorf South

- 24th Street Looking East



City of San Antonio



SAN ANTONIO  
RIVER AUTHORITY  
Leaders in Watershed Solutions



# Status Report

## Elmendorf Lake

- Commerce Looking West



## Elmendorf Lake

- Commerce Looking East



# Status Report

## Elmendorf South

- Look East to 24th Street



## Elmendorf South

- Looking west to Commerce Street



# Status Report

- Apache / San Pedro Hike and Bike Trails
  - 10' wide hike and bike linear creekway trails.
    - Apache 1.49 miles
    - San Pedro 2.01 miles
  - Estimated Completion – February 2016
  - Project Progress Page
    - <http://www.westsidecreeks.com/apachesan-pedro-creekways-trail-progress/>



City of San Antonio



SAN ANTONIO  
RIVER AUTHORITY  
Leaders in Watershed Solutions



THE WATER DIVISION OF ARCADIS



Watershed Ebooks  
PROFESSIONAL PROGRAM



# Status Report

## Apache

– S. Zarzamora Looking West



## Apache

– S. Zarzamora Looking East



City of San Antonio



SAN ANTONIO  
RIVER AUTHORITY  
Leaders in Watershed Solutions



The Water Division of ARCADIS



25

# Status Report

- Alazan / Martinez Hike and Bike Trails
  - 10' wide hike and bike linear creekway trails.
    - Alazán 0.47 miles
    - Martinez 0.61 miles
  - Estimated Completion – January 2016
  - Project Progress Pages
    - <http://www.westsidecreeks.com/alazan-creekway-trail-progress/>
    - <http://www.westsidecreeks.com/martinez-creekway-trail-progress/>



# Status Report

## Martinez

– Woodlawn Looking North



## Martinez

– Woodlawn Looking South



City of San Antonio



SAN ANTONIO  
RIVER AUTHORITY  
Leaders in Watershed Solutions



The Water Division of ARCADIS



27

# Status Report

## Alazan – Waverly Looking South



## Alazan – Waverly Looking North



# Questions?



City of San Antonio



SAN ANTONIO  
RIVER AUTHORITY  
Leaders in Watershed Solutions



The Water Division of ARCADIS



Watershed Ebooks

*WESTSIDE CREEKS SIGNAGE*



## LEGEND



**INTERPRETIVE SIGN**

## ALAZAN CREEK TRAIL

1. Casting Pond
  - a. West End Lake
  - b. Fish hatchery
2. Neighborhood History
  - a. Basilica of the National Shrine of the Little Flower
  - b. Old Protestant Orphan
  - c. Peacock Academy



City of San Antonio

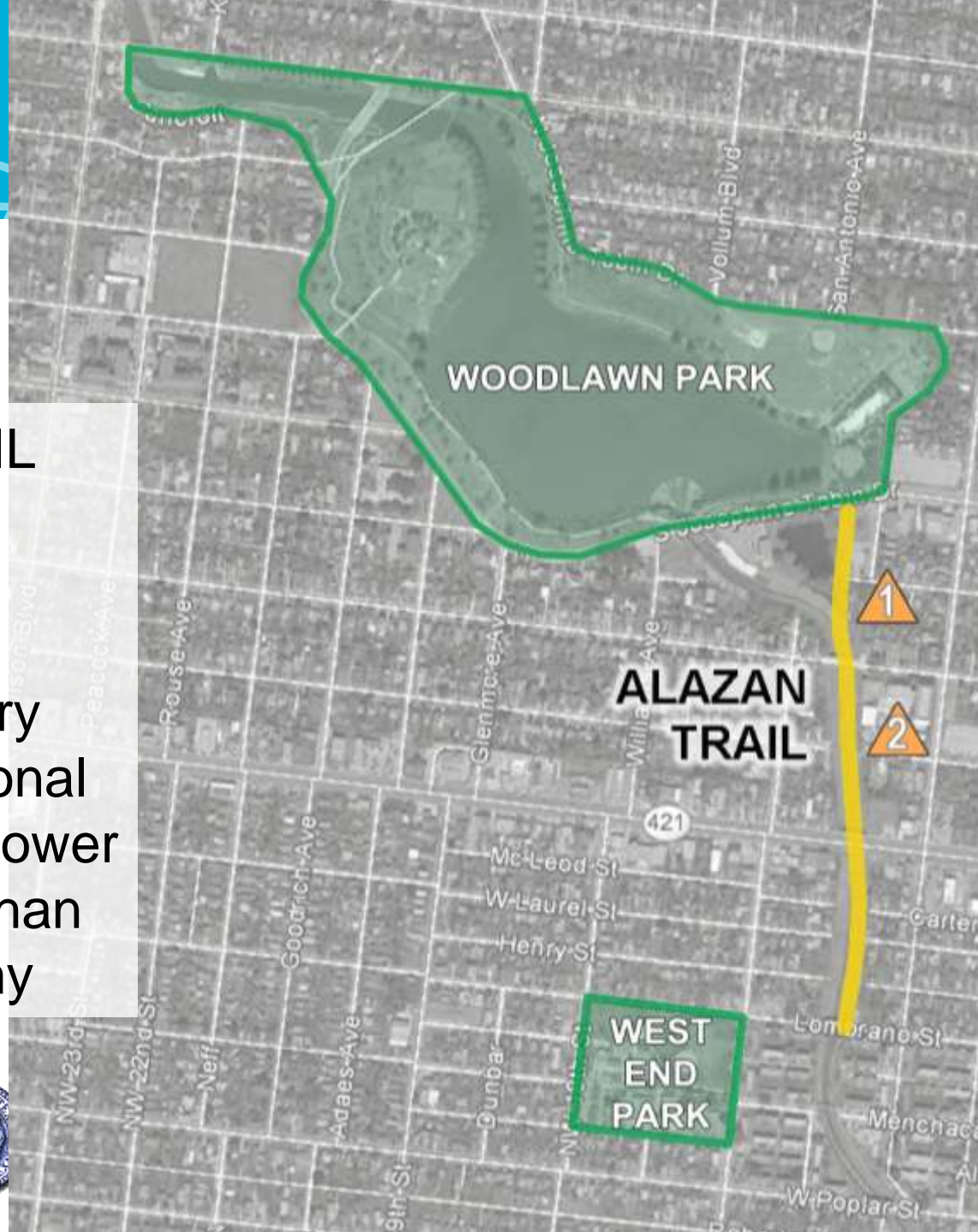

## LEGEND



INTERPRETIVE SIGN

## MARTINEZ CREEK TRAIL

1. Neighborhood Culture
  - a. Deco District
  - b. Oak Farms Dairy
  - c. Miniature Golf
2. Manmade Impacts
  - a. Flood Control
  - b. Expressway
  - c. Roads and Streets



City of San Antonio

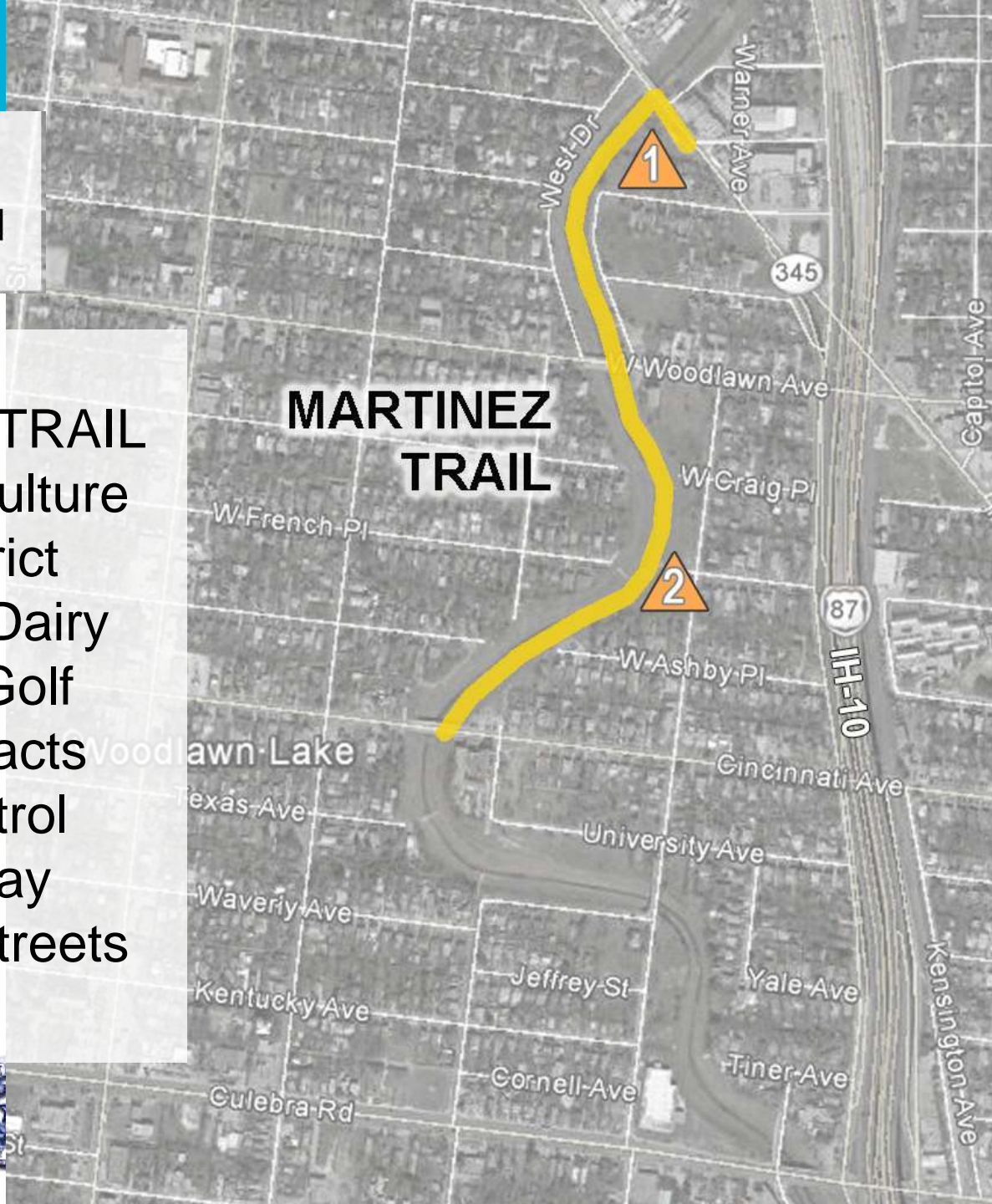



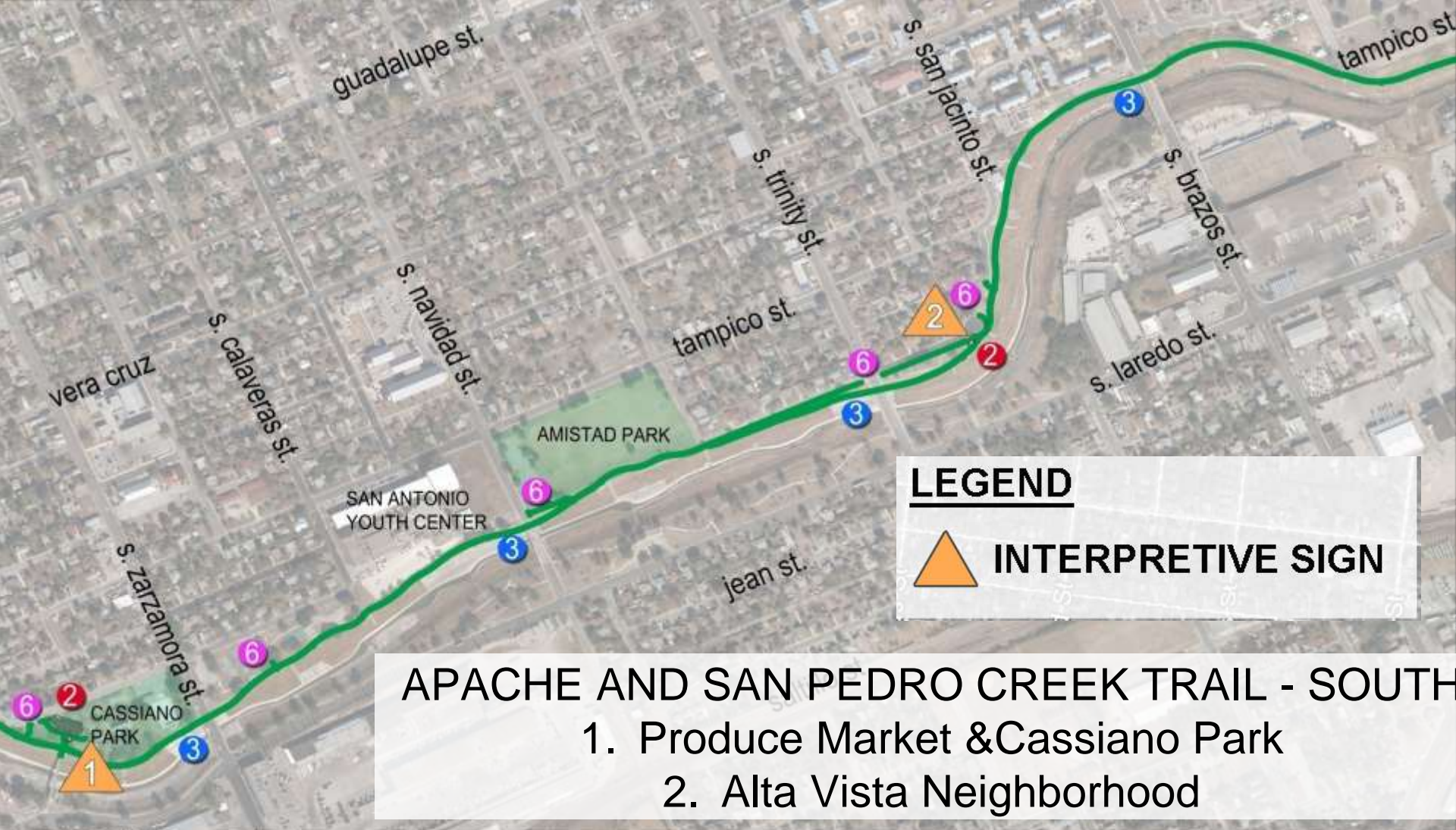

# APACHE AND SAN PEDRO CREEK TRAIL - SOUTH

1. Produce Market & Cassiano Park
2. Alta Vista Neighborhood

## LEGEND

- |                         |                                     |                                  |
|-------------------------|-------------------------------------|----------------------------------|
| <b>1</b> TRAIL NODE     | <b>3</b> BELOW STREET CROSSING      | <b>6</b> NEIGHBORHOOD CONNECTION |
| - TRAILHEAD SIGNAGE     |                                     |                                  |
| - TRAIL MAP PEDESTAL    |                                     |                                  |
| - INTERPRETIVE PEDESTAL |                                     |                                  |
| - PARK RULES SIGNAGE    | <b>4</b> BELOW TRAIN TRACK CROSSING | <b>7</b> AT STREET CROSSING      |
| - SHADE STRUCTURE       |                                     |                                  |
| - PICNIC TABLE          |                                     |                                  |
| - BIKE RACK             | <b>5</b> PETER REED BASEBALL FIELD  | <b>INTERPRETIVE SIGN</b>         |
| <b>2</b> TRAIL HEAD     |                                     |                                  |
| - PARKING LOT           |                                     |                                  |
| - TRAILHEAD SIGNAGE     |                                     |                                  |
| - TRAIL MAP PEDESTAL    |                                     |                                  |
| - INTERPRETIVE PEDESTAL |                                     |                                  |
| - SHADE STRUCTURE       |                                     |                                  |
| - PICNIC TABLE          |                                     |                                  |
| - BIKE RACK             |                                     |                                  |

## LEGEND

 INTERPRETIVE SIGN

# APACHE AND SAN PEDRO CREEK TRAIL – SOUTH

- 3. San Fernando Cemetery
- 4. Alazan Creek Confluence
- 5. San Pedro Creek Confluence
- 6. Railroads & Stockyards
- 7. Expressway

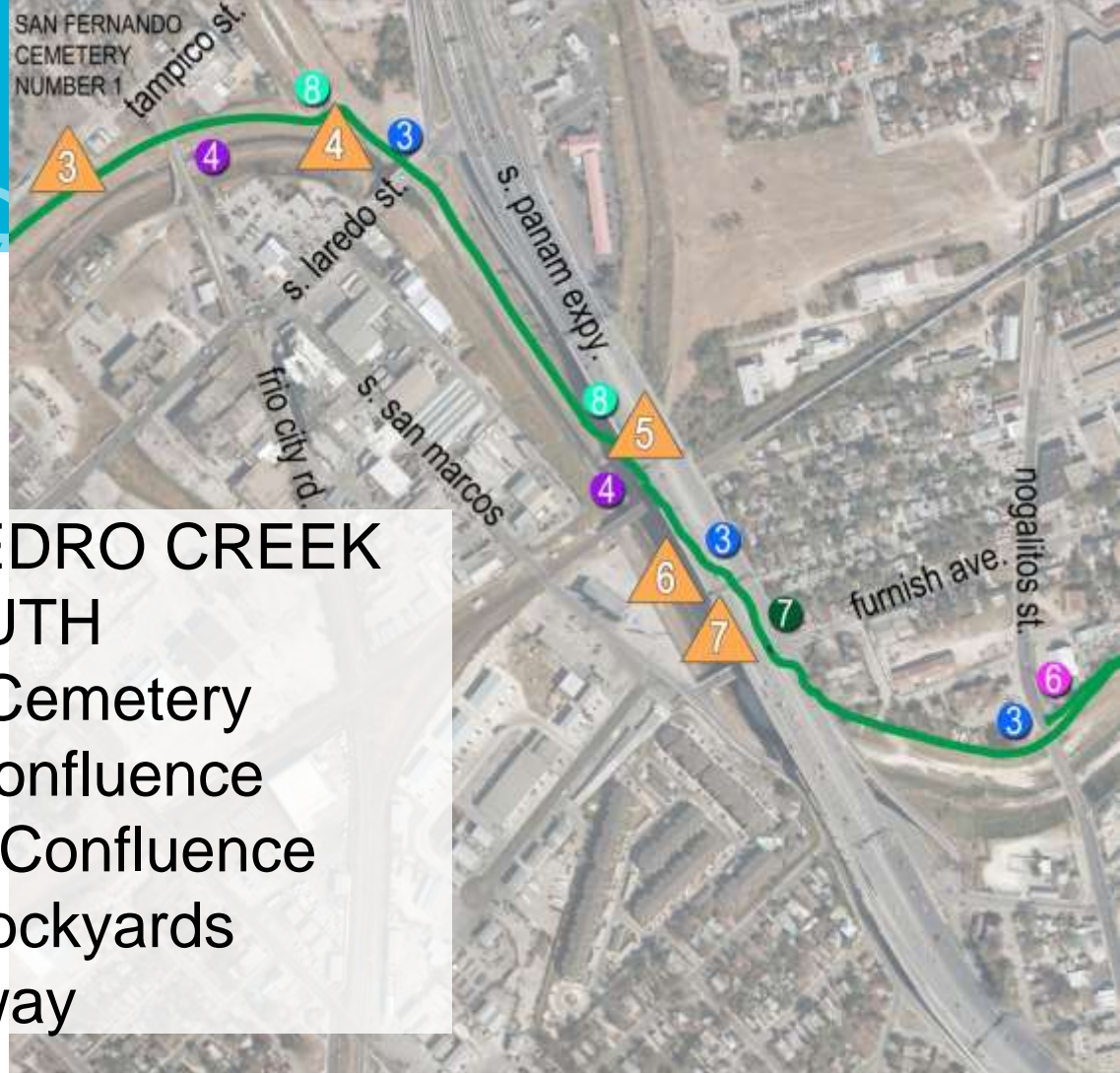

## LEGEND

 **1 TRAIL NODE**

- TRAIL HEAD SIGNAGE
- TRAIL MAP PEDESTAL
- INTERPRETIVE PEDESTAL
- PARK RULES SIGNAGE
- SHADE STRUCTURE
- PICNIC TABLE
- BIKE RACK

 **2 TRAIL HEAD**

- PARKING LOT
- TRAIL HEAD SIGNAGE
- TRAIL MAP PEDESTAL
- INTERPRETIVE PEDESTAL
- SHADE STRUCTURE
- PICNIC TABLE
- BIKE RACK

 **3 BELOW STREET CROSSING**

 **4 BELOW TRAIN TRACK CROSSING**

 **5 PETER REED BASEBALL FIELD**

 **6 NEIGHBORHOOD CONNECTION**

 **7 AT STREET CROSSING**

 **8 LOW WATER CROSSING**

 INTERPRETIVE SIGN



City of San Antonio



# LEGEND



INTERPRETIVE SIGN

## APACHE AND SAN PEDRO CREEK TRAIL – SOUTH 8. Beanville

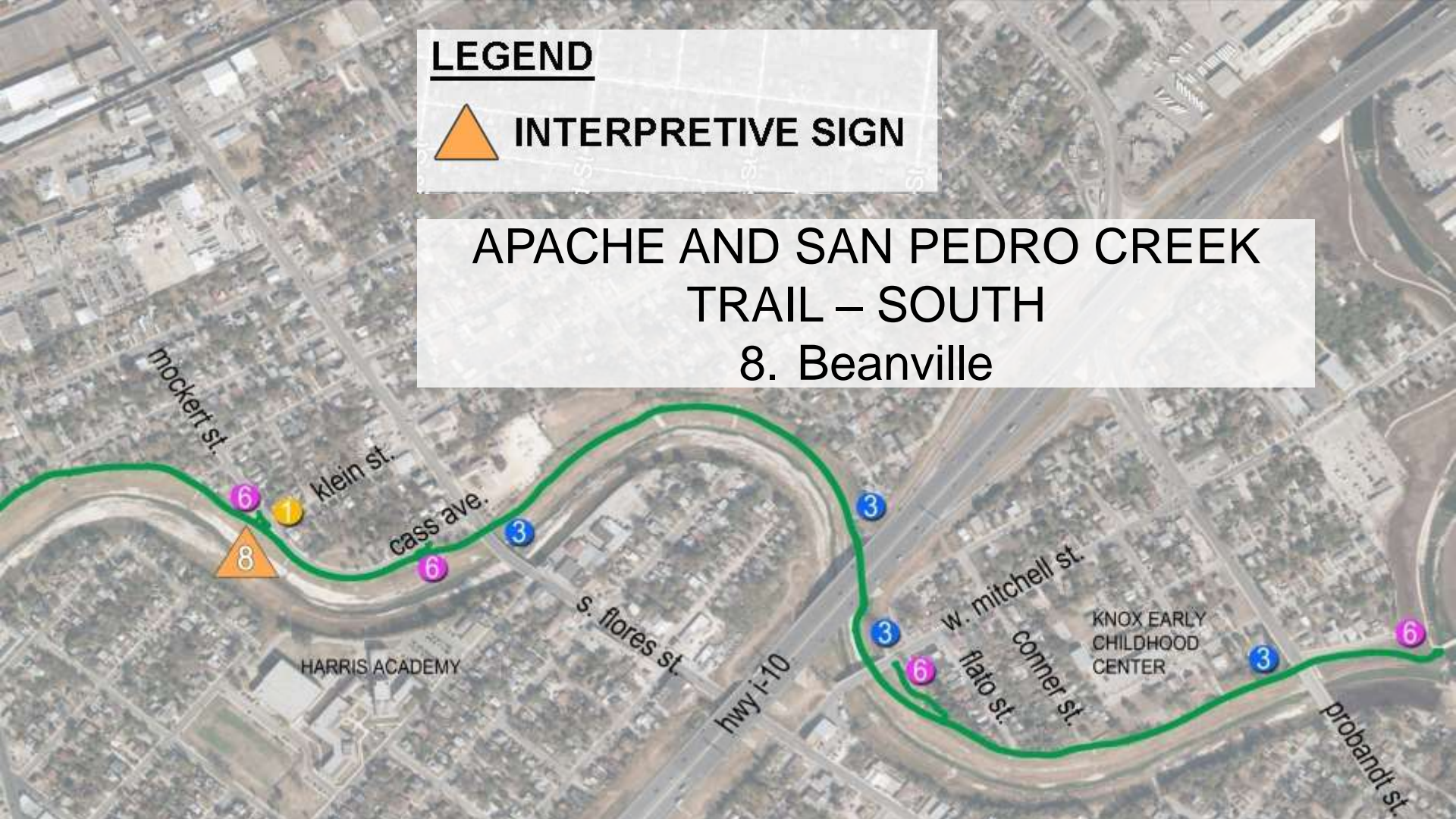

### LEGEND



TRAIL NODE

- TRAIL HEAD SIGNAGE
- TRAIL MAP PEDESTAL
- INTERPRETIVE PEDESTAL
- PARK RULES SIGNAGE
- SHADE STRUCTURE
- PICNIC TABLE
- BIKE RACK



TRAIL HEAD

- PARKING LOT
- TRAIL HEAD SIGNAGE
- TRAIL MAP PEDESTAL
- INTERPRETIVE PEDESTAL
- SHADE STRUCTURE
- PICNIC TABLE
- BIKE RACK



BELOW STREET CROSSING



BELOW TRAIN TRACK CROSSING



NEIGHBORHOOD CONNECTION



AT STREET CROSSING





LOW WATER CROSSING



INTERPRETIVE SIGN



**LEGEND**

-  INTERPRETIVE SIGN
-  SUGGESTED ENVIRONMENTAL / WATER QUALITY SIGNS

**ELMENDORF LAKE PARK**

3.17.15







## ELMENDORF LAKE PARK

1. History of the Park
2. Culture and Neighborhood of the Westside
3. Life Above the Lake
4. Bioswale Purpose and Function
5. Local Stories & Pastimes
6. Life Below the Lake
7. Invasive Plants

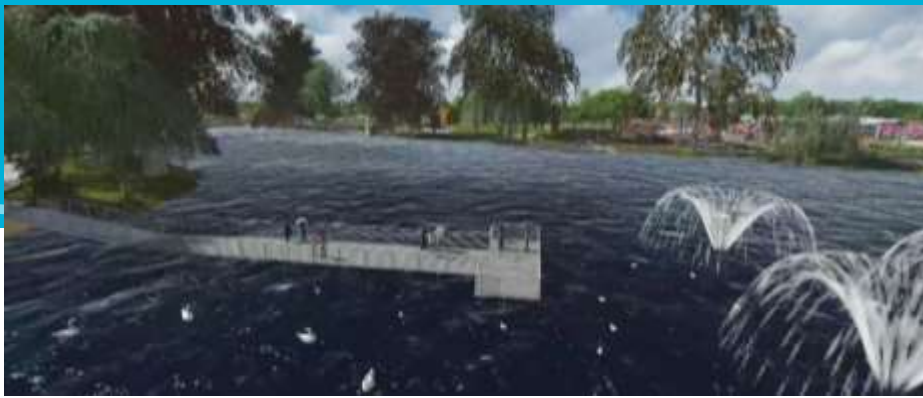



### LEGEND

-  INTERPRETIVE SIGN
-  SUGGESTED ENVIRONMENTAL / WATER QUALITY SIGNS

## ELMENDORF LAKE PARK

8. Swimming, boating and celebrations
9. Apache Creek Water shed
10. Bald Cypress
11. OLLU and the park
12. Water Cycle
13. History of the Island
14. Local Stories and Pastimes
15. Restoring Water Quality
16. Damming and Channeling the Creek



# THE CASTING POND

Mesquite-filled pasture land along the banks of upper Alazan Creek turned into a marsh when the creek overflowed its banks in times of heavy rain. In 1887 real estate speculators bought property along the creek northwest of the congested city and formed the West End Town Company to develop a new neighborhood. The company beautified the isolated subdivision with a lake created by damming the creek. Spring rains soon filled the lake as well as a small pond that formed in the excavation pit just below the dam. Recognizing that rainfall was unpredictable, developers dug artesian wells to assure a constant lake level as well as water for household use.

A trolley running across the dam transported city residents out to the lake to boat, picnic, and fish. From 1933 until about 1950, the city operated a fish hatchery in the lower pond. Bass and catfish raised there were used to stock both the lake and the San Antonio River. After the hatchery closed, the picturesque spot became known as the casting pond and remained a popular destination for picnics and fishing. The pond had deteriorated and filled with silt by the late 1900s, but it was restored DATE and remains a popular destination for visitors to Woodlawn Lake.



SAN ANTONIO  
RIVER AUTHORITY  
Leaders in Watershed Solutions



The Water Division of ARCADIS



GREETINGS FROM  
SAN ANTONIO  
TEXAS



NIC TENCO

WEST END LAKE



City of San Antonio



SAN ANTONIO  
RIVER AUTHORITY  
Leaders in Waters





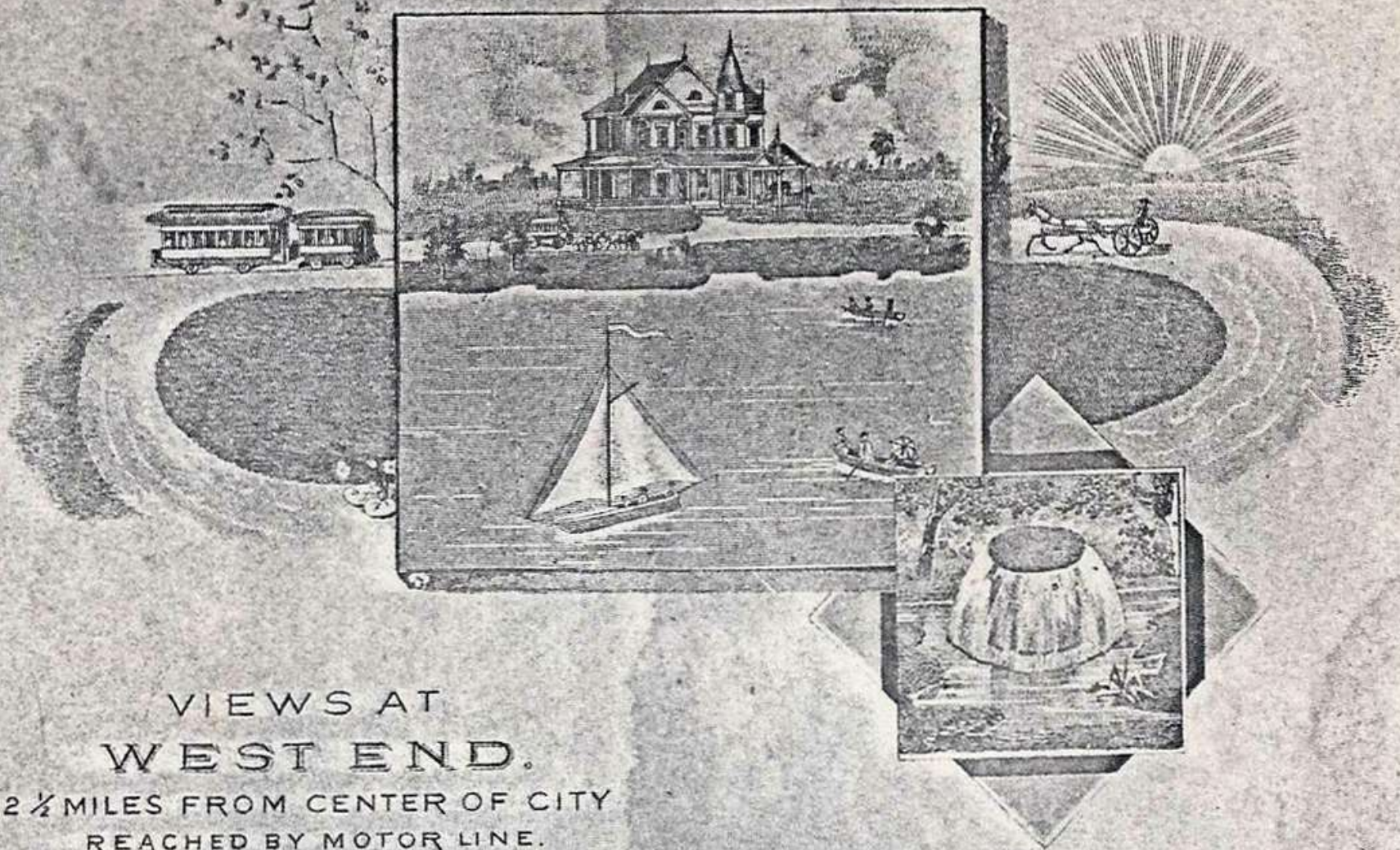

VIEWS AT  
WEST END.

2 ½ MILES FROM CENTER OF CITY  
REACHED BY MOTOR LINE.



# BOERNE DAM

## FIRST BUSINESS IN BOERNE

The first business in Boerne used the natural resource of the Cibolo Creek. In 1854, William Dietert left Germany, where his family had been millwrights for generations, and sailed for Texas aboard the *Fruwziska*. That same year, he built a gristmill and dam on the Cibolo. The hard-working Dietert family later built dams and gristmills in Comfort, Fredericksburg, and Kerrville.



### DID YOU KNOW?

A gristmill is a mill where the water provides power to grind grains such as grinding wheat into flour.



ARTISTIC CONCEPTION OF WILLIAM DIETERT'S GRISTMILL.



OLD DAM ORIGINALLY BUILT BY WILLIAM DIETERT IN 1856. IMAGE CIRCA 1900.



NEW DAM BUILT IN EARLY 1910S. IMAGE CIRCA 1920.



WILLIAM DIETERT'S HOUSE, 1944.

## WILLIAM DIETERT'S HOUSE

Near the dam is William Dietert's original house at 604 E. River Road built in 1860. Although it is now a commercial building, you can still see signs that it is an old building with the stonework and the building's compact form. It is one of Boerne's earliest buildings and it has served many uses in its days such as a tavern and house while the gristmill was in service. It had undergone many uses and changes, but was recently restored to its more original form a few decades ago.



# RIVER AND CITY

## INTERACTIONS BETWEEN KERRVILLE AND GUADALUPE RIVER

### OVERVIEW

The Guadalupe River links Hunt, Ingram, Kerrville, and Center Point and then travels east to Comfort in Kendall County. This linkage has an impact on commercial and agricultural activity as well as water availability and quality. Heavy rainfall in the upper Guadalupe River watershed can have flood impact on all of these communities.

### DID YOU KNOW?

The hilltops on both sides of the Guadalupe River can be as much as 300 feet higher than the river level. Elevation change and large areas of impervious surfaces can cause rapid drainage to the river. *Be aware of flood alerts and warnings.*

### KERRVILLE DEVELOPMENT

The site of the first settlement in the area, Joshua Brown's shingle-making camp, was on the top of the north bluff of the Guadalupe River near what is now downtown Kerrville. By the end of the 1800's, Kerrville had developed into a small, vibrant community. The river supplied power for grist mills and saw mills, and later generated electric power. Today the Guadalupe River is the major water supply for Kerrville and communities along it. Since building structures in floodplains is restricted, several parks, including the Kerrville River Trail, have been developed along the banks of the Guadalupe River for public enjoyment.



INDUSTRY BY THE WATER



OLD BALD CYPRESS DAM

### THE FLOOD OF 1932

The July 1932 flood is the "flood of record" in Kerrville and crested at 39 feet above normal river level. Most of the city was built on the elevated northern side of the river and the floodwaters spread across the floodplain on the southern side. Major damage was limited. In 1978, another large flood rose to crest just under the Sidney Baker Bridge.



THE FLOOD OF 1932 ON THE GUADALUPE RIVER



DOWNTOWN KERRVILLE

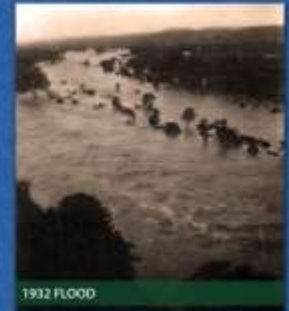

1932 FLOOD

# Biofiltration

## Did You Know?

Dense, thickly planted grasses filter out sediment and pollution from runoff of impervious surfaces, such as buildings and roads.

## Bioswales And Rain Gardens

Bioswales and rain gardens improve water quality by absorbing and filtering runoff through selected plants and soils. They are strategically located to intercept storm water runoff, often found along edges of parking areas and streets, mitigating potential pollution from entering our rivers and streams.

Fischer Park has rain gardens at each of its main parking lots. Several rain gardens throughout an area are better than one.



BIOSWALE AT LANDA PARK GOLF COURSE

IMAGE SOURCE: Parker Space

## Special Plants

The plants selected for the rain garden and bioswale are able to withstand the extremes of both flooding and drought. Deep-rooted native plants are ideal for rain gardens and bioswales because they encourage infiltration, filter pollutants, and control erosion. Native plants are well adapted to climate and resist local pests and diseases. The selection of the right plants is crucial to the overall success of the garden.

## Collecting Storm Water

Bioswales along the parking areas at Fischer Park have been designed, installed, and lined with plants to absorb runoff water. During heavy rains, excess water is directed into the bioswales which filters slowly and absorbs into the ground. This also helps recharge groundwater, supplying rivers and streams with a steady, purified water source.



HUMMINGBIRD MINT (*Agastache scabra*)

IMAGE SOURCE: Dick Gilbert



OBEDIENT PLANT (*Physostegia indica*)

IMAGE SOURCE: Gina Wilburn



MAIDEN GRASS (*Miscanthus sinensis*)

IMAGE SOURCE: Matt Lavin

## Filtering Storm Water

Below the surface of rain gardens, the selected plants and soils are hard at work cleaning the water. Once it is absorbed into the ground, sediment, nitrogen and phosphorous levels in the water are reduced by the combined actions of the plants, root systems and soils.



MUHLY GRASS (*Muhlenbergia* spp.)

IMAGE SOURCE: Sam Kennedy



MEXICAN FEATHER GRASS (*Stipa sp.*)

IMAGE SOURCE: Jeffrey Jordan



City of San Antonio



SAN ANTONIO  
RIVER AUTHORITY  
Leaders in Watershed Solutions





LAKE PLAZA SEATING



INTERACTIVE FOUNTAIN



LAKE PLAZA ENTRY





BEACH ENTRY SWIMMING POOL / PLAYGROUND / ADULT EXERCISE AREA



SWIMMING POOL



BEACH ENTRY



SWIMMING POOL



SAN ANTONIO RIVER AUTHORITY

MALCOLM PIRNIE

ARCADIS



ELMENDORF LAKE PARK IMPROVEMENTS



TERRA DESIGN GROUP, INC.



TRAIL NODE WITH CANTILEVERED PIER



INTERPRETIVE SIGNS

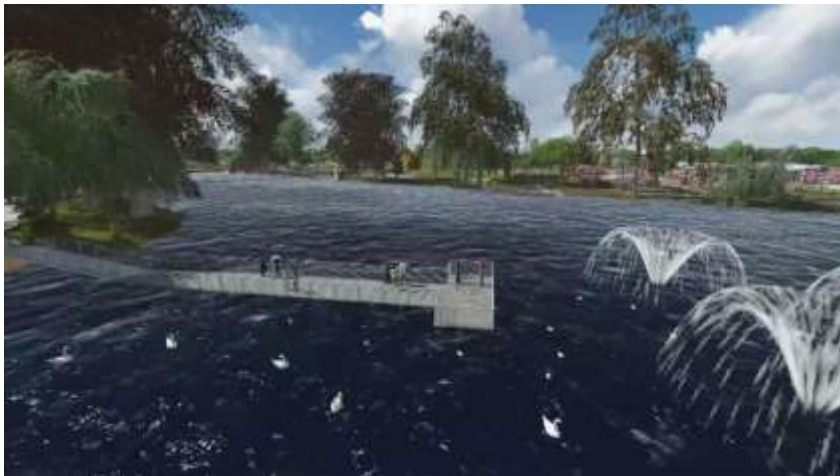

"T" HEAD FISHING PIER



PARK MONUMENT SIGN

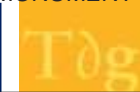

# ELMENDORF LAKE PARK IMPROVEMENTS







COMMERCE STREET FILTERING RAIN GARDEN



PARKING LOT FILTERING RAIN GARDEN



NORTH PARK WETLAND / BIOSWALE



FILTERING RAIN GARDEN AT SHORE DRIVE PARKING



# ELMENDORF LAKE PARK IMPROVEMENTS





EAST PARK WETLAND



SAN ANTONIO RIVER AUTHORITY



# ELMENDORF LAKE PARK IMPROVEMENTS



TERRA DESIGN GROUP, INC.



COMMERCE STREET PEDESTRIAN BRIDGE



TRAIL NODE AT 24<sup>TH</sup> AND COMMERCE STREET



TRAIL UNDER COMMERCE STREET



TRAIL WITH SEATING NODES ALONG LAKE SHORE



# ELMENDORF LAKE PARK IMPROVEMENTS





City of San Antonio



SAN ANTONIO  
RIVER AUTHORITY  
Leaders in Watershed Solutions



The Water Division of ARCADIS



Watershed Ebooks  
PROVIDING INSIGHT



Commerce Street



Pedestrian Bridges



City of San Antonio



SAN ANTONIO RIVER AUTHORITY  
Leaders in Watershed Solutions



The Water Division of ARCADIS



PROCESOS Y PRODUCTOS



Hike and Bike Trails



Stream bank Restoration



City of San Antonio



SAN ANTONIO RIVER AUTHORITY  
Leaders in Watershed Solutions



The Water Division of ARCADIS



PROFESSIONAL ENGINEERS



Commerce Street



Bio-Retention



City of San Antonio



SAN ANTONIO RIVER AUTHORITY  
Leaders in Watershed Solutions



The Water Division of ARCADIS





City of San Antonio



SAN ANTONIO RIVER AUTHORITY  
Leaders in Watershed Solutions

MALCOLM PIRNIE

ARCADIS

The Water Division of ARCADIS

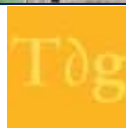





Pervious Pavement



Pervious Pavement



City of San Antonio



Commerce Street

24th Street

Cascading waterfall for Aeration



City of San Antonio



SAN ANTONIO RIVER AUTHORITY  
Leaders in Watershed Solutions



PROFESSIONAL PROJECT



Commerce Street

24th Street



Property Acquisition



City of San Antonio



SAN ANTONIO RIVER AUTHORITY  
Leaders in Watershed Solutions



The Water Division of ARCADIS



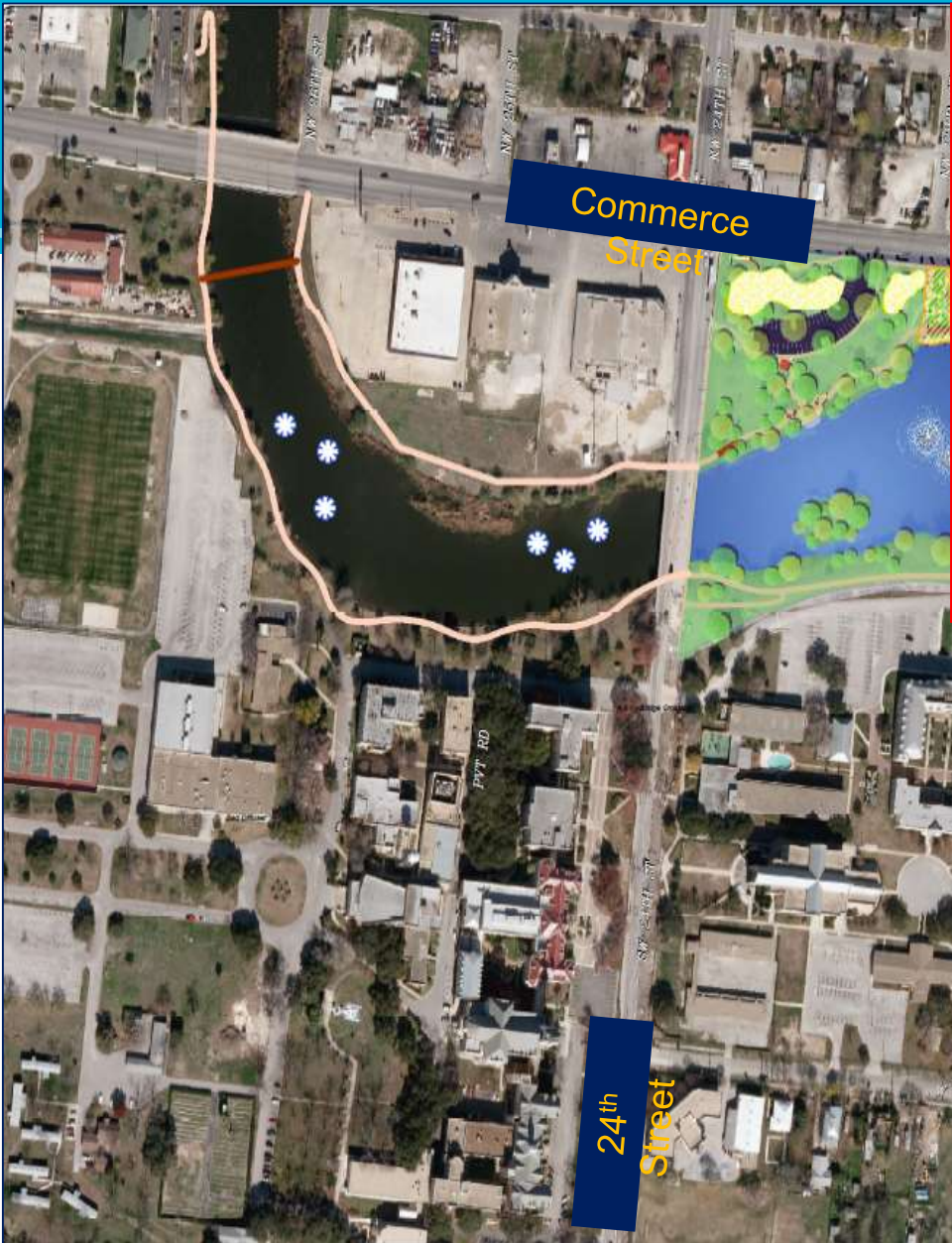

City of San Antonio



SAN ANTONIO RIVER AUTHORITY  
Leaders in Watershed Solutions

MALCOLM PIRNIE



The Water Division of ARCADIS



# SAN PEDRO CREEK IMPROVEMENTS PROJECT



SAN ANTONIO  
RIVER AUTHORITY  
Leaders in Watershed Solutions



# 40% to 70% Design

- ❖ Incorporation of stakeholder input
- ❖ Progression of design details
  - ❖ Engineering and architectural design
  - ❖ Drawings and specifications
- ❖ HAER field work for historic walls (Historic American Engineering Record; documentation of existing project features)
- ❖ Quality control reviews and coordination for 70% submittal
- ❖ Utility coordination and relocation design
- ❖ Determined final project limits and property to support design
- ❖ Reconciliation of project funding



# COMMUNITY INPUT





# Public Input & Outreach



- ❖ Three Public Events
- ❖ Four San Pedro Creek Subcommittee Meetings
  - ❖ Present updates on design development monthly
- ❖ Public Survey
- ❖ Property Owner Coordination
  - ❖ 19 private parcels, 15 owners
  - ❖ 1 to 5 meetings with each owner
- ❖ Media Outreach
- ❖ Updates posted regularly on project website:  
[spcproject.org](http://spcproject.org)

# COMMUNITY SURVEY

■ YES ■ NO

HAVE YOU ATTENDED ANY OF THE  
SAN PEDRO CREEK WORKSHOPS ?

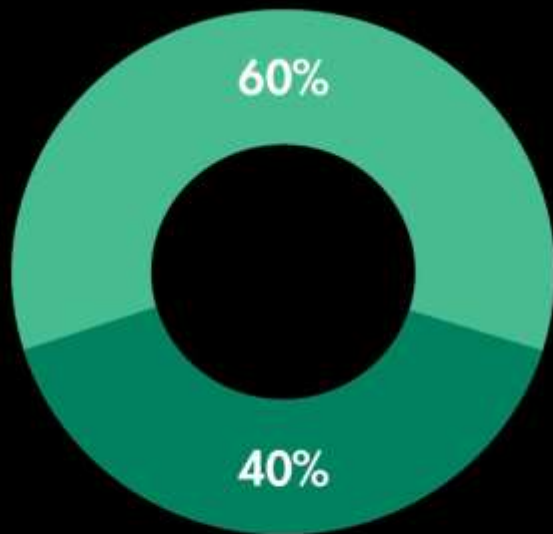

HAVE YOU ATTENDED ANY SAN PEDRO  
CREEK SUBCOMMITTEE MEETINGS ?

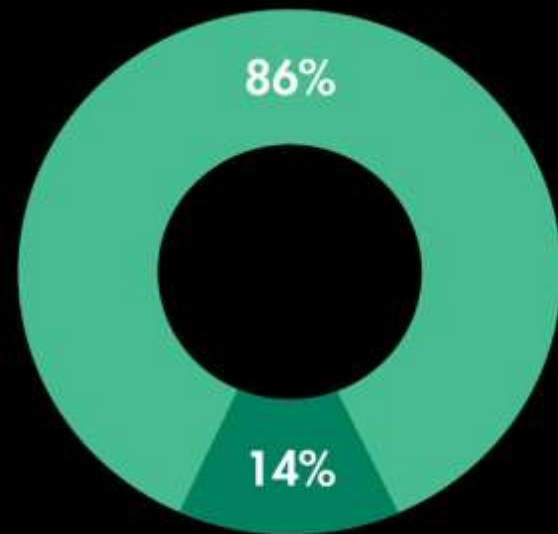

# COMMUNITY SURVEY DESIGN PREFERENCE

REALLY LIKE LIKE DON'T LIKE

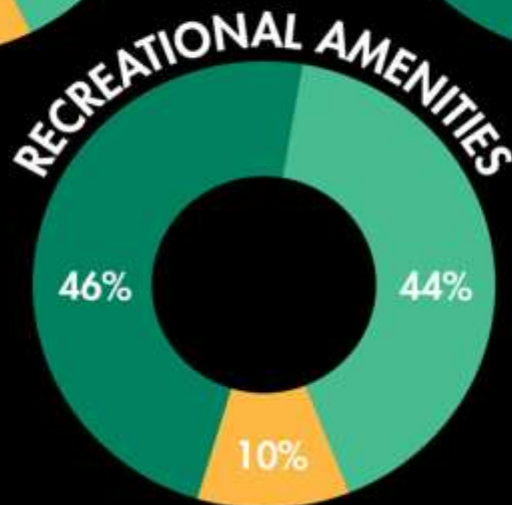
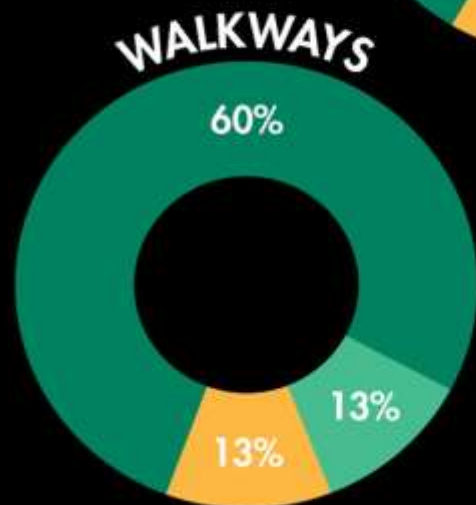
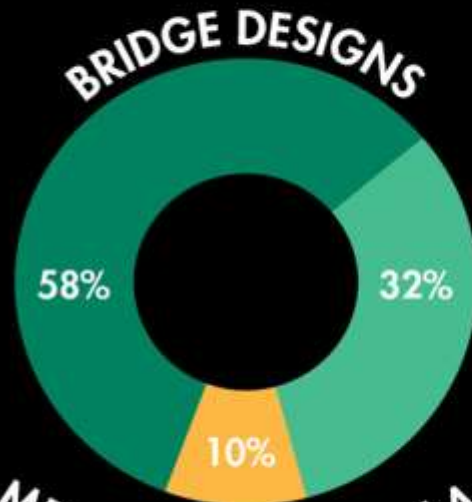
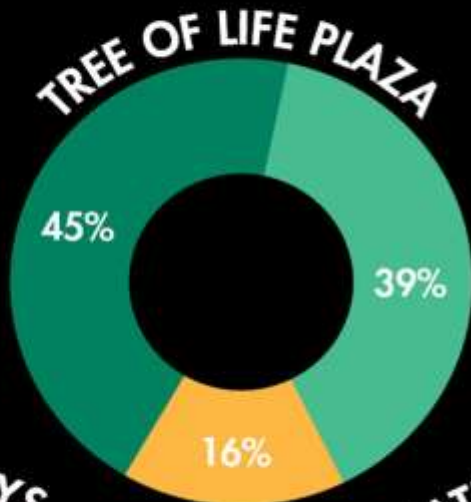

# COMMUNITY SURVEY DESIGN PREFERENCE

REALLY LIKE LIKE DON'T LIKE

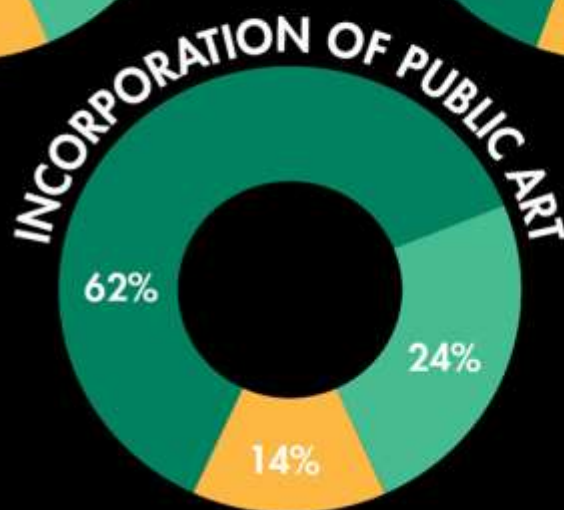
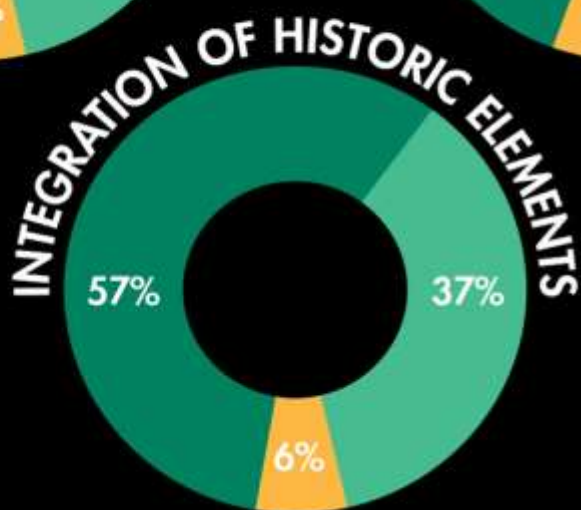
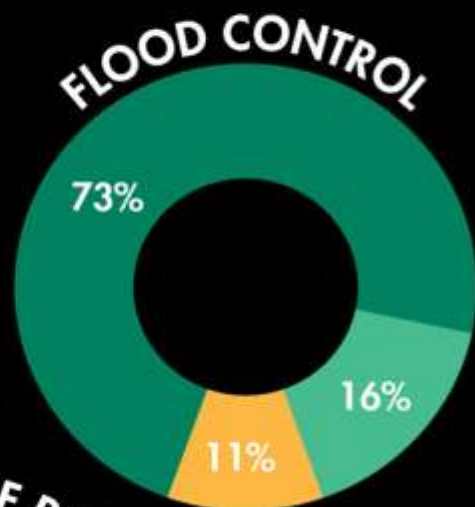
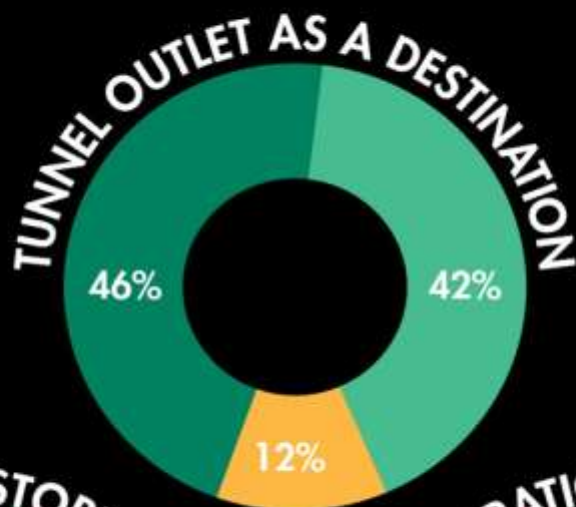
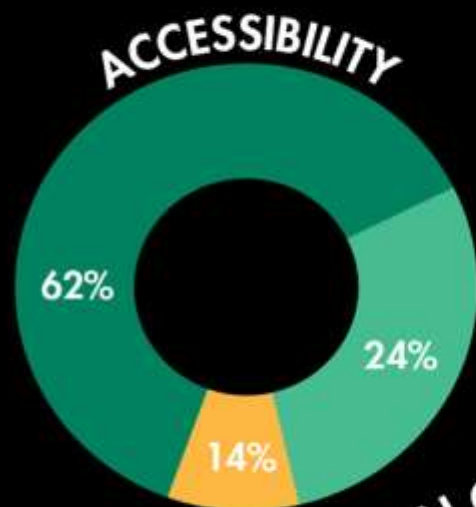

# COMMUNITY SURVEY DESIGN PREFERENCE

REALLY LIKE LIKE DON'T LIKE

## WATER QUALITY FEATURES

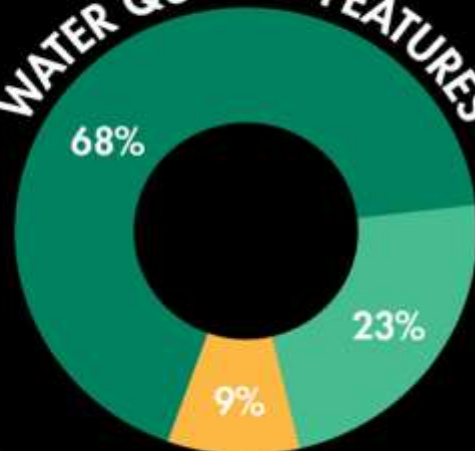

## HABITAT IMPROVEMENTS

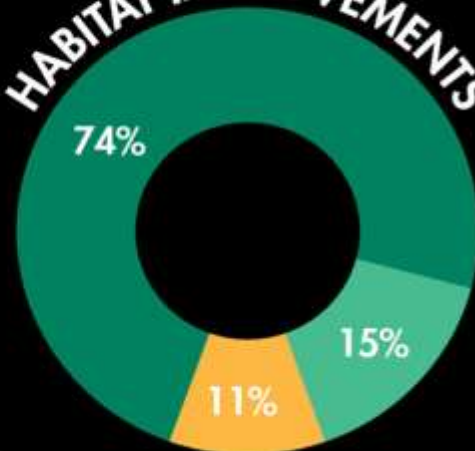

## VISIBILITY OF WATER IN THE CREEK

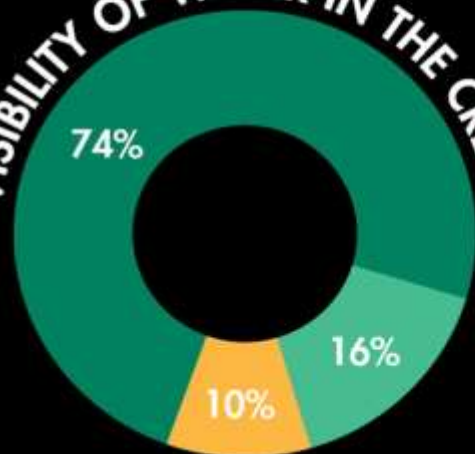

## FEATURES THAT NURTURE/PROTECT

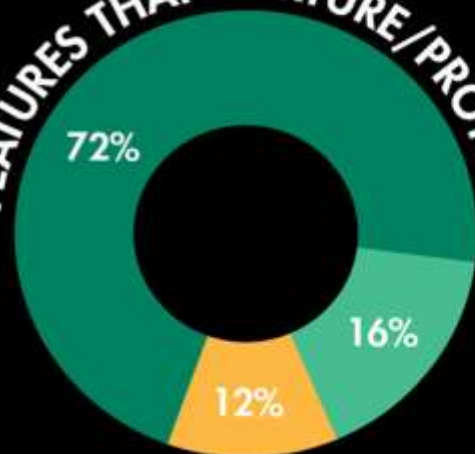

# COMMUNITY SURVEY

WHAT IN THE PROJECT IS MOST IMPORTANT TO YOU?



# Design Input Response

- ❖ Pathway forward from 70% design: Response to Public, Stakeholder and Property Owner Concerns, Value Engineering, and Cost Reduction
  - ❖ Tree of Life Arch and Plaza
  - ❖ Salinas bridge shade structure (art curation)
  - ❖ Alameda amphitheater and plaza
  - ❖ Merodeo **“tree bridge”** artistic treatment (art curation)
  - ❖ Architectural finishes and detailing: integral concrete color, wall finishes and paving pattern selection, architectural railing selection, and pavers at roadways

# Design Input Response, Cont.



- ❖ Pathway forward from 70% design, Cont.
  - ❖ Phase 2 as flood control only (full scope completed if funding available)
  - ❖ Solidify construction phasing
  - ❖ Focus design on Phase 1 & 2
    - ❖ Progress design for phases 3 and 4, behind phases 1 and 2



**AUGUST 11 • 70%**

40%



70%



40%



70%



40%



70%



**LANDSCAPE**



# KEY PROJECT ELEMENTS

## **SAN PEDRO CREEK** (all character areas)

- 2 miles of channel
- 10.3 acres of landscaped area
- 1,000 trees

## **PHASE 1**

- 0.7 miles of channel
- 2.8 acres landscaped area
- 350 trees

## **MUSEUM REACH**

- 1.3 miles of channel
- 3.0 acres landscaped area
- 270 trees

**PUBLIC ART**

# SPCCP PUBLIC ART ADVISORY COMMITTEE

## FUNCTIONS:

- Administrative support provided by Munoz & Company and SARA
- Sets the stage for how public art will be received and build unified support
- Advises designers through the public art process
- Advises on an implementation plan
- Meets regularly and as-needed
- Recruits and participate with the community, artists, and design team on the bridge storytelling & concepts

# ADVISORY COMMITTEE



**JORGE RODRIGUEZ-GERADA**  
*International Artist / SPC Consultant*



**PATRICIA RUIZ-HEALY**  
*Director Ruiz-Healy Art*



**FELIX PADRON**  
*Director, CoSA Department of Culture and Creative Development*



**KATHRYN KANJO**  
*Trustee Linda Pace Foundation*



**CALEB ETHEREDGE**  
*Member SPC Subcommittee (landscape architect)*



**BETTY BUECHE**  
*Director Bexar County Heritage & Parks Department*



**EDUARDO GARCIA**  
*Vice Chair PASA Public Art Committee (mayoral appointment)*

# SPCCP PUBLIC ART ADVISORY COMMITTEE SCHEDULE

The primary milestone is for public art concepts to be delivered to Bexar County and SARA with the 100% Design Documents Review Submittal by 21 December 2015. Secondary milestones will need to be established in order to achieve this goal according to the rough timeline below.

## **AUGUST 1 - 31**

Assemble Art Development Committee  
*Munoz & Company*

Construction phasing direction  
*BC/SARA*  
*Munoz & Company*

Determine submission requirements  
and solicitation  
*SPCCP Public Art Advisory Committee*

Conduct community storytelling sessions  
*Munoz & Company*  
*BC/SARA*

Assemble project briefs for bridges and select  
installations  
*SPCCP Public Art Advisory Committee*  
*Munoz & Company*

Identify, invite and recommended select artists  
*SPCCP Public Art Advisory Committee*  
*Munoz & Company*

## **SEPTEMBER 1 - OCTOBER 31**

Receive and review Initial submission concepts  
*SPCCP Public Art Advisory Committee*  
*Munoz & Company*

## **NOVEMBER 1 - 30**

Recommend short list and/or final artists for  
concept development  
*SPCCP Public Art Advisory Committee*  
*Munoz & Company*  
*BC/SARA*

Art concept development  
*Selected artists*  
*Munoz & Company*

## **DECEMBER 1 - 21**

Art concept review/presentation  
*San Antonio Arts Commission*  
*Historic and Design Review Commission*  
*BC/SARA*

Art concept development and Submittal  
*Selected artists*  
*Munoz & Company*

## **JANUARY 1 - 29**

Concept refinement and approval  
*Selected artists*  
*SPCCP Public Art Advisory Committee*  
*Munoz & Company*  
*BC/SARA*

**COMMUNITY BASED  
DESIGN PROJECT:  
BRIDGES OF UNDERSTANDING**

**14 BRIDGES**

**WHERE THE CREEK INTERSECTS THE URBAN FABRIC**

**HEAL THE CULTURAL DIVIDE**

**OPPORTUNITY FOR A COMMUNITY  
BASED PROCESS OF STORY TELLING**

**ARTISTIC DESIGN OF NON STRUCTURAL  
COMPONENTS AND SURFACES**

# Total Project Costs

## **Preliminary Engineering Report (2013)**

- Total - \$175M
  - Conceptual cost estimate
  - High-level study to determine project's feasibility

## **70% Design Development (2015)**

- Total - \$206.8M
  - Market conditions thru 2017
  - Refined design
  - Better understanding of existing infrastructure
  - Additional structural elements (e.g. walls)
  - Limited property costs

**Total Project Costs Increase at 18.2%**

# 40% Design Construction Phasing





# Proposed Construction Phasing



# Going Forward to 90% Design



## ❖ Focus design on Phases 1 & 2

- ❖ Advance Public Art Development process; adding pedestrian bridges and increasing total art allocation to \$3 million
- ❖ Explore design options for modified location of amphitheater
- ❖ Refine design documents to reflect modifications based on public input
- ❖ Phase 2 to proceed with flood control improvements only (no amenities) to meet primary project goal within limited available funding
- ❖ Evaluate design scope based on final direction for phases 1 and 2

## ❖ Continue design for Phases 3 & 4 once Phase 1 & 2 Bid Documents are complete

# Next Steps

- ❖ August 2015: 70% Design Deliverable Approval
- ❖ November 2015: 90% Design Deliverable Approval
- ❖ February 2016: Final Design
- ❖ May 2016: Start Construction
- ❖ May 2018: Complete significant section for 300<sup>th</sup> Anniversary

# Recommendation

- ❖ Recommended Motion:
  - ❖ Approval of the 70% intermediate design documents as required by the Cooperative Agreement between Bexar County and the San Antonio River Authority
  - ❖ Direct staff and the San Antonio River Authority to finalize design scope and proceed with the completion of 90% design documents for Phase 1 & 2 to be presented to Commissioners Court on current schedule and deliver Phase 3 & 4 at a future date

# SAN PEDRO CREEK

IMPROVEMENTS PROJECT



SAN ANTONIO  
RIVER AUTHORITY  
Leaders in Watershed Solutions