



San Pedro Creek
improvements **Project**
CONNECTING COMMUNITIES

JUNE 20, 2017



DESIGN & CONSTRUCTION

PROJECT DEVELOPMENT

Phase 1, Segment 1- (Tunnel Inlet to Houston Street)

- 90% design plan submittal in February 2017
- Progress of construction in Phase 1, Segment 1 on schedule for completion on May 5, 2018



PROJECT DEVELOPMENT

Phase 1, Segment 2- (Houston Street to Cesar Chavez Blvd)

- 90% design plan submittal
 - Dependent upon final approval of art elements by Commissioners Court
 - Additional art elements require revisions to the design that will impact schedule for submittal
- SDJV will submit an initial cost estimate for Phase 1, Segment 2 in August and a full GMP eight weeks after 90% design submittal

DESIGN DEVELOPMENT

Phase 2- (Guadalupe Street to South Alamo Street)

- Design for Phase 2 will resume upon completion of design for Phase 1



CONSTRUCTION ACTIVITIES



CONSTRUCTION ACTIVITIES



CONSTRUCTION ACTIVITIES



CONSTRUCTION ACTIVITIES



CONSTRUCTION ACTIVITIES

Construction tours held for public, stakeholders, students, committee members, elected officials





ART PROGRAM

Bridges: Santa Rosa, Martin, Travis

East Bank between Travis Street and Houston Street

West Bank between Travis Street and Houston Street

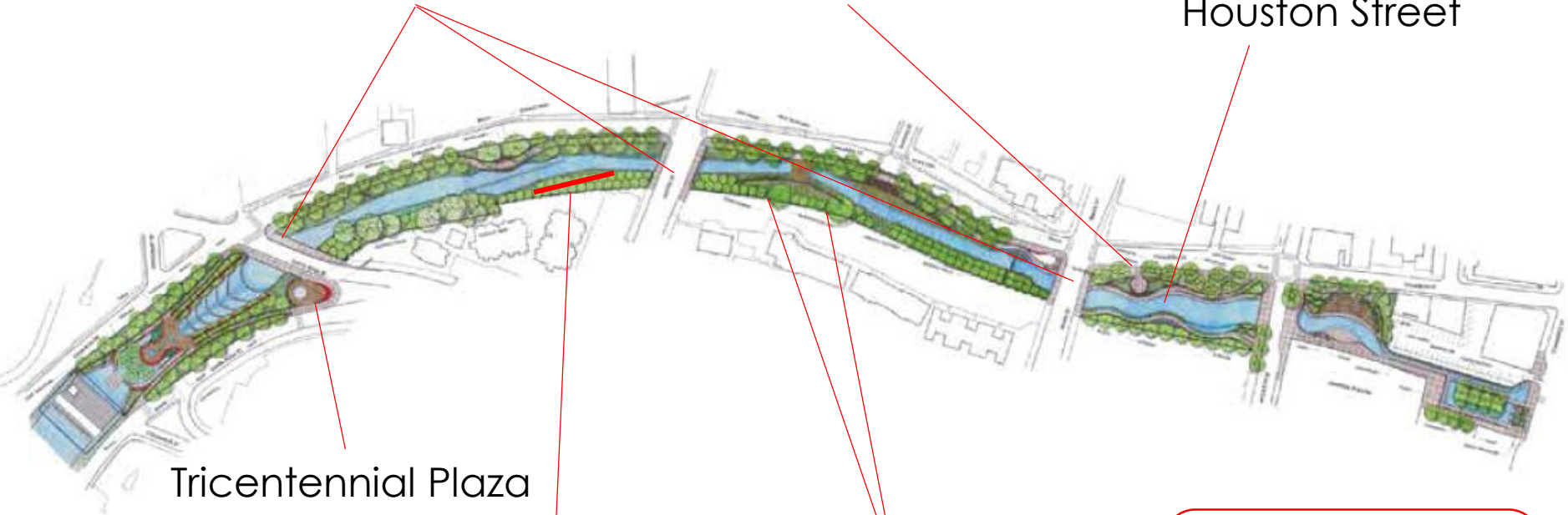

Tricentennial Plaza

West Bank between Santa Rosa Street and Martin Street

West Bank between Martin Street and Travis Street

Tile Patterns and Word Art: multiple locations

Permanent Artwork Overview



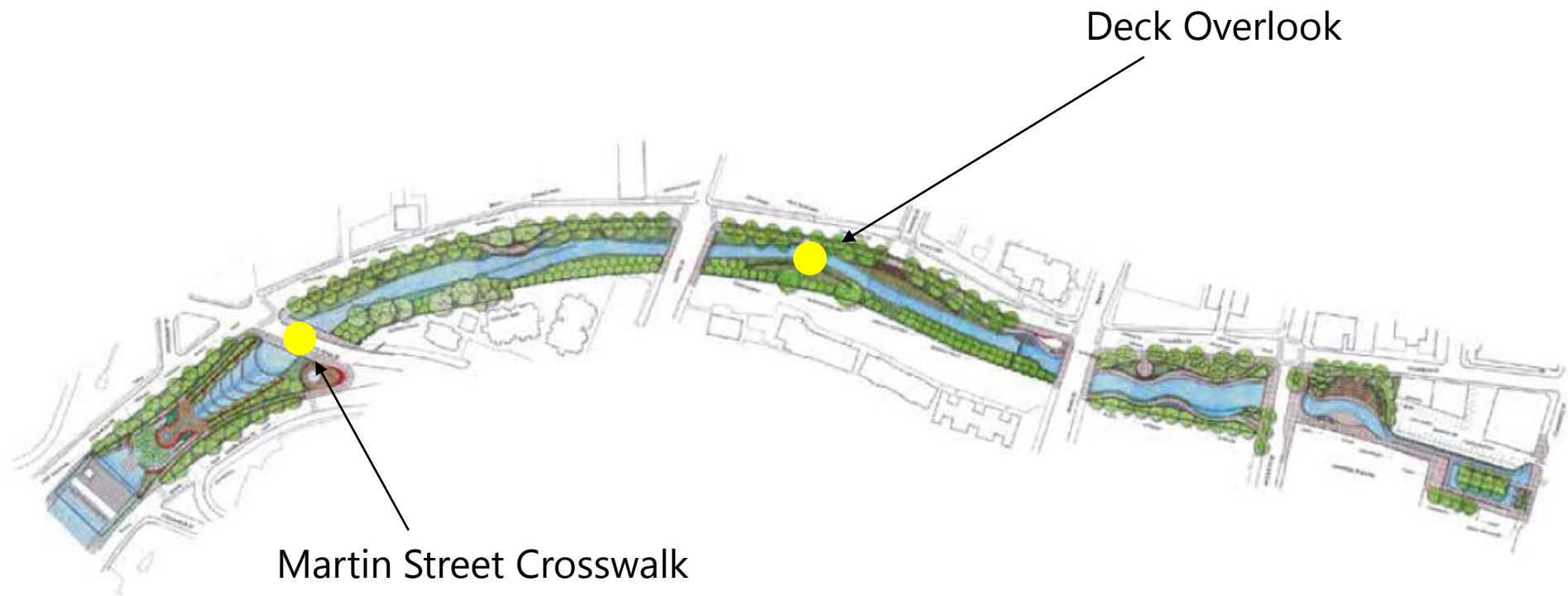

Temporary Artwork Overview



JORGE RODRIGUEZ-GERADA

American artist based in Barcelona, Spain

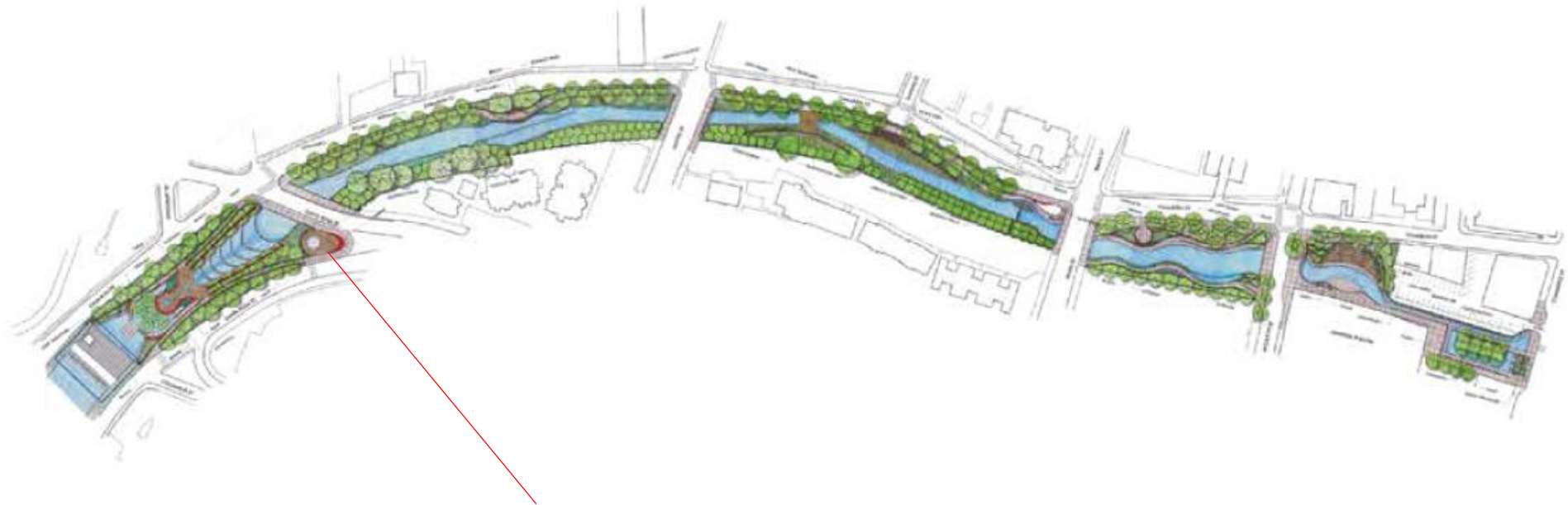

Tricentennial Plaza



Concept

Stainless steel and aluminum



“Plethora refers to the sustenance that San Pedro Creek represents to the San Antonio community. The title of the sculpture, phonetically understood in both Spanish and English, alludes to the great abundance of water and how it irrigates the social fabric that feeds, grows and recognizes itself through a collective outlook, just like the primordial path of the water.”



Concept

Stainless steel and aluminum



DIANA KERSEY

San Antonio, TX

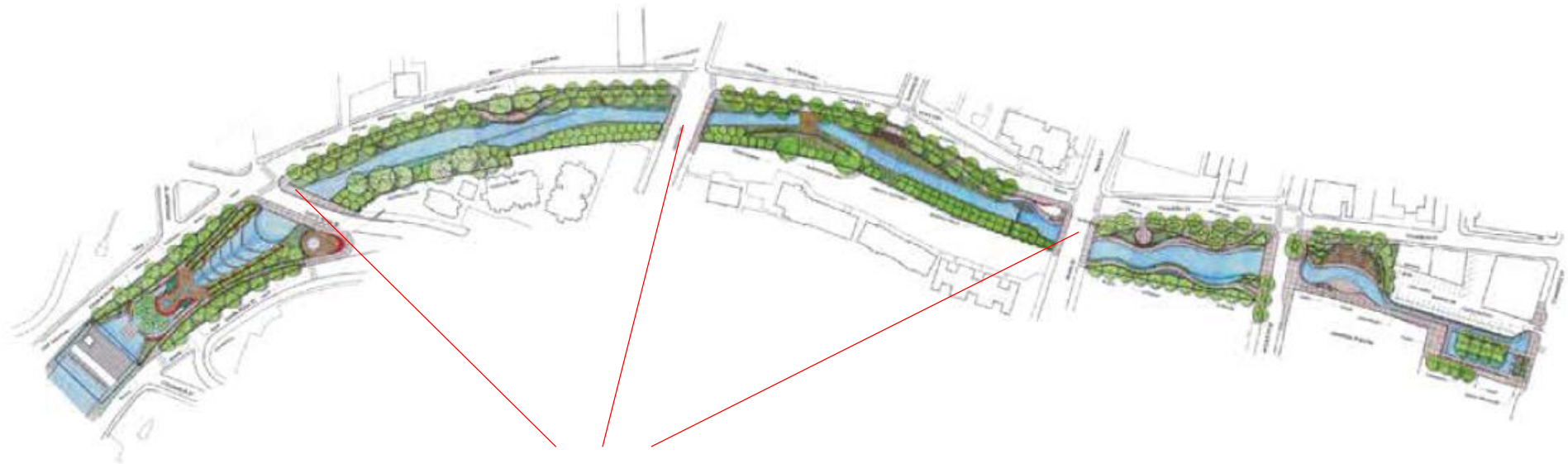

Bridges: Santa Rosa, Martin, Travis



Concept

Ceramic inserts at street level

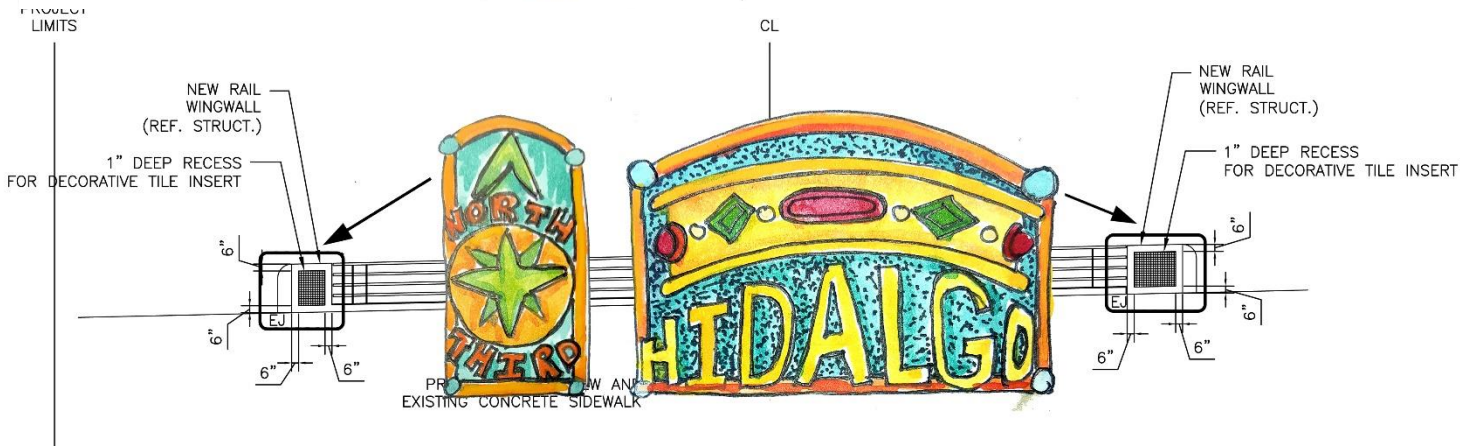

MICHAEL MENCHACA JOHN PHILLIP SANTOS

San Antonio, TX

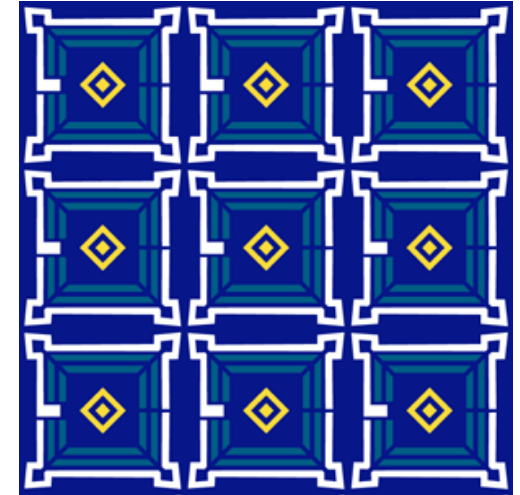
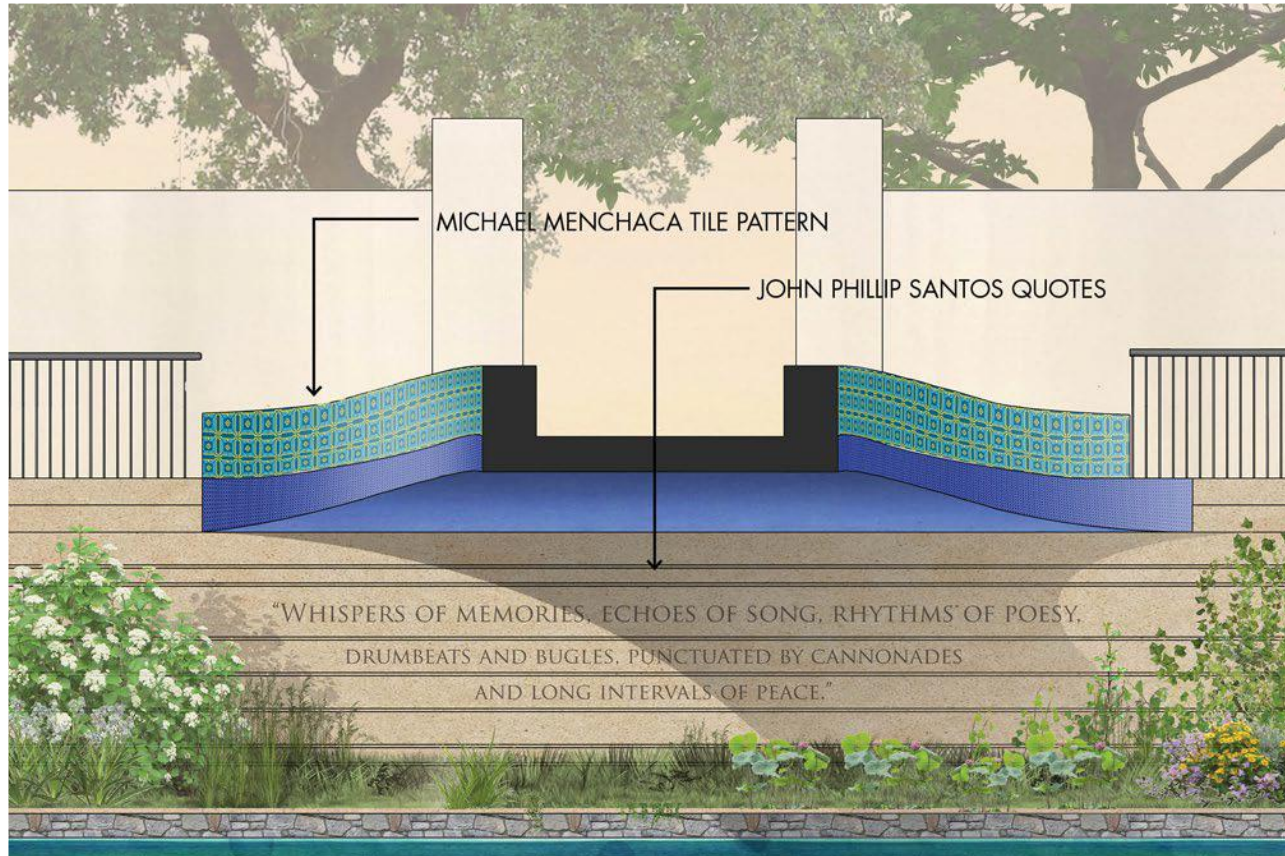

Tile Patterns and Word
Art: multiple locations



ADRIANA GARCIA

San Antonio, TX

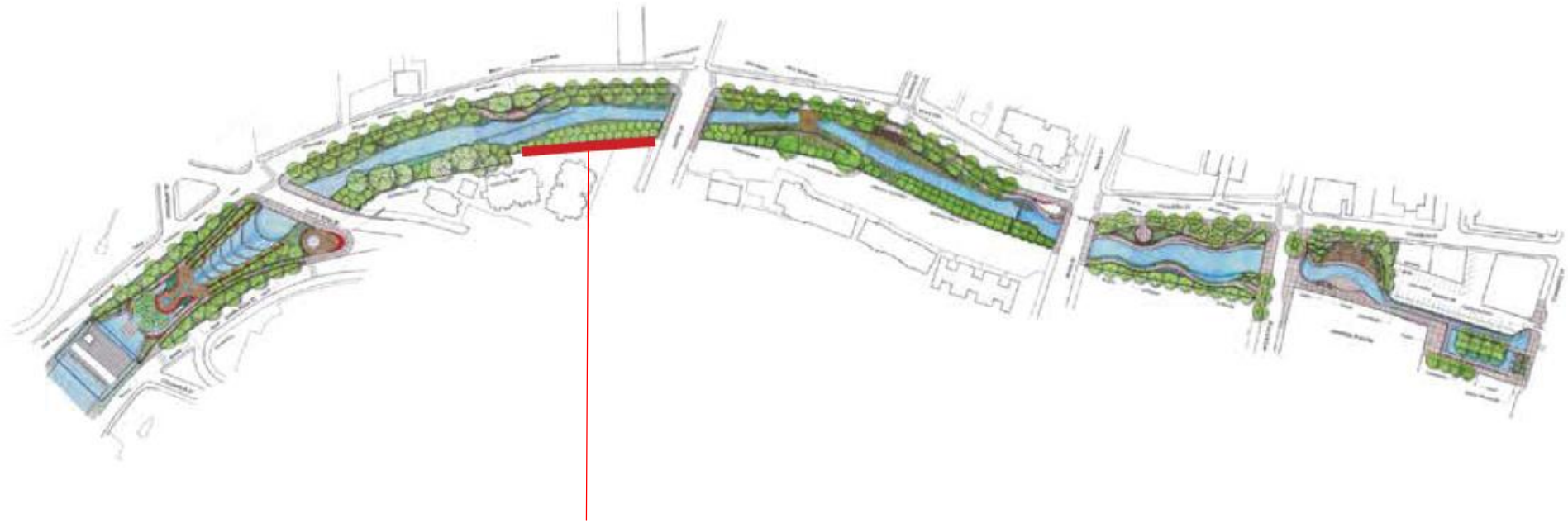

West Bank between Santa Rosa Street and Martin Street



Theme: From All Roads, We Are One

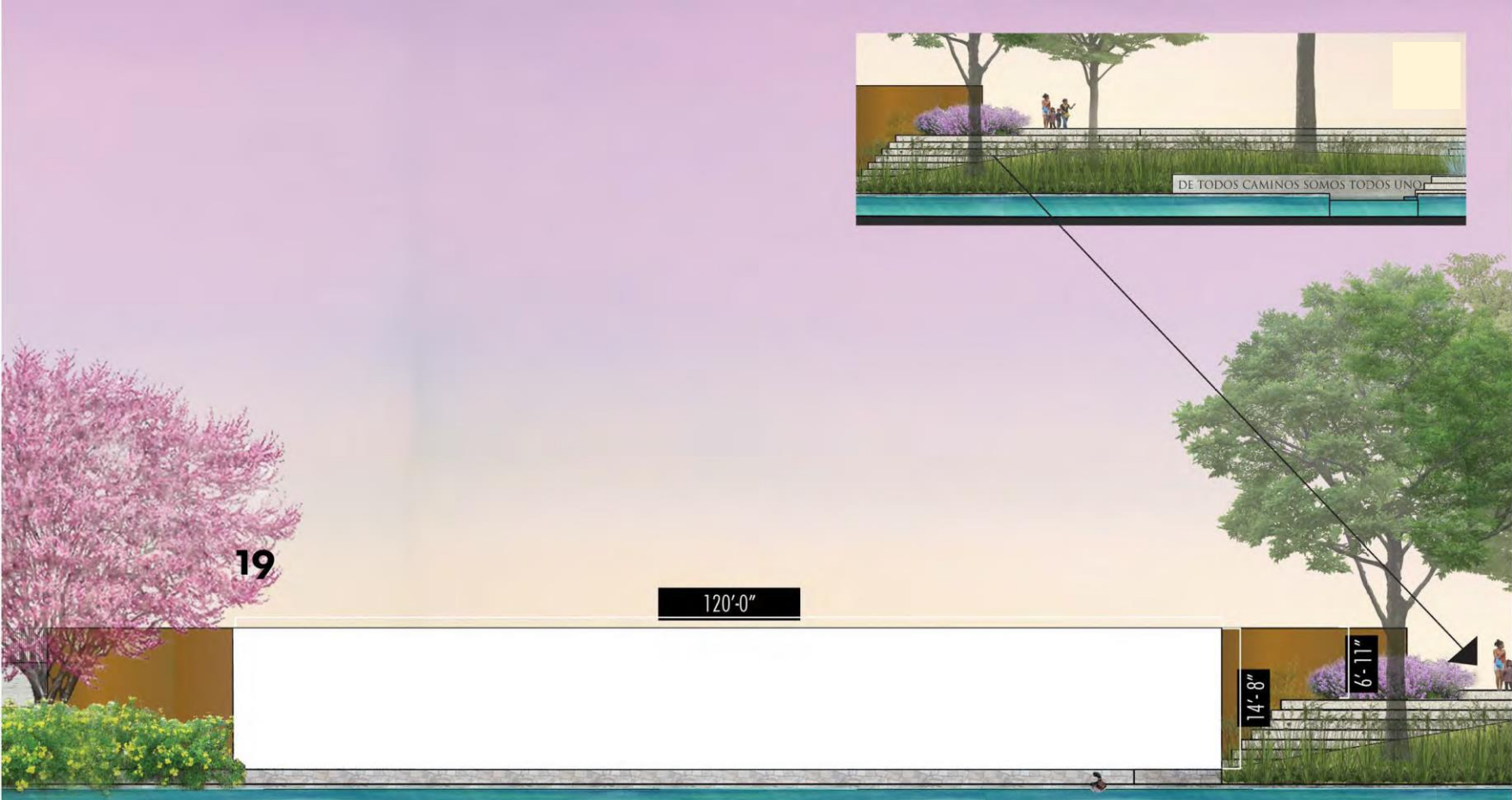

Concept

Painted mural converted to ceramic tile



“The composition tells the story of how the springs brought forth growth in San Antonio. The left is to represent the west, the right is to represent the east.”



KATIE PELL

San Antonio, TX

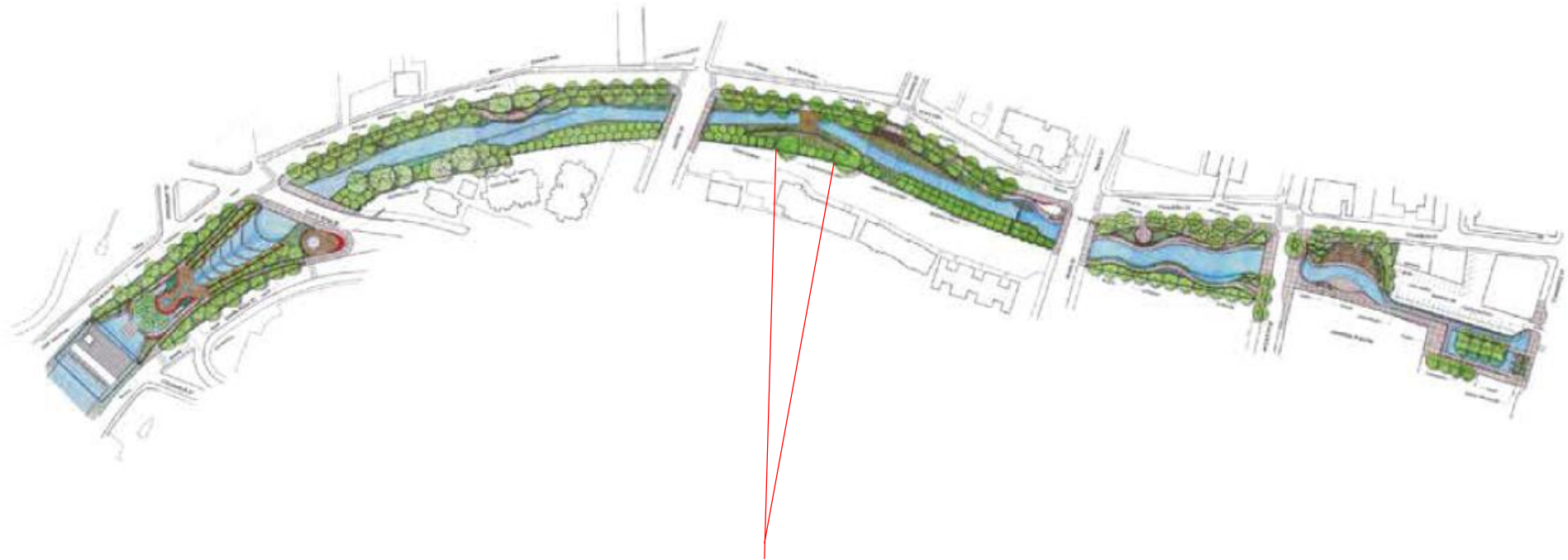

West Bank between Martin Street and Travis Street



Theme: Lost Wildlife



Concept

Painted mural converted to ceramic tile



People rendered for scale



ALEX RUBIO

San Antonio, TX

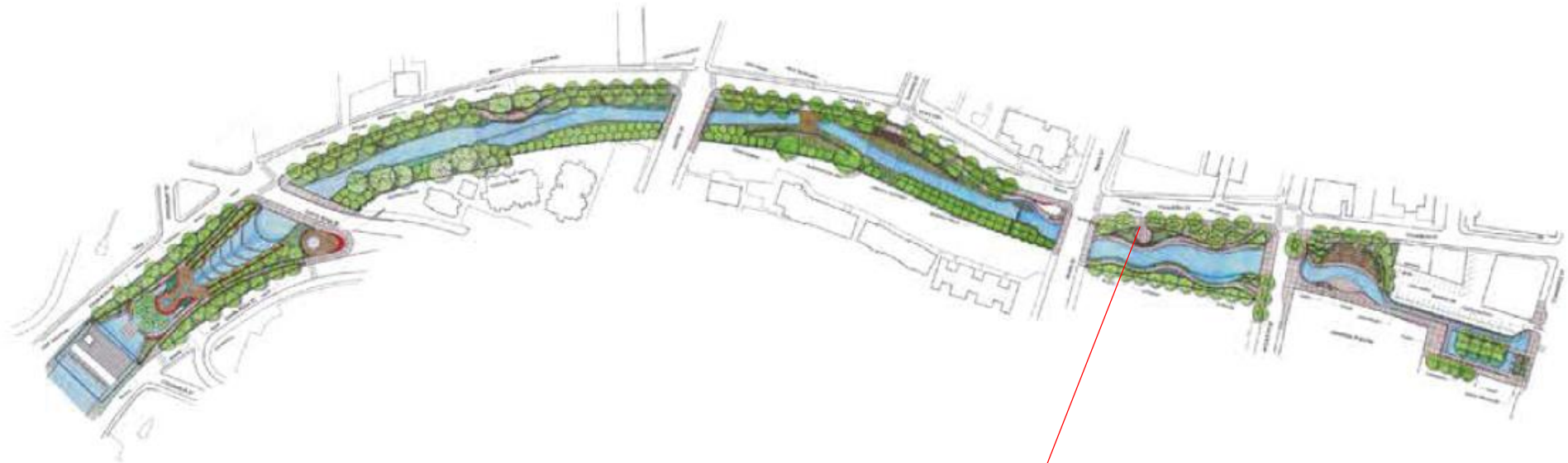

East Bank between Travis Street and Houston Street



Theme: Water Flow

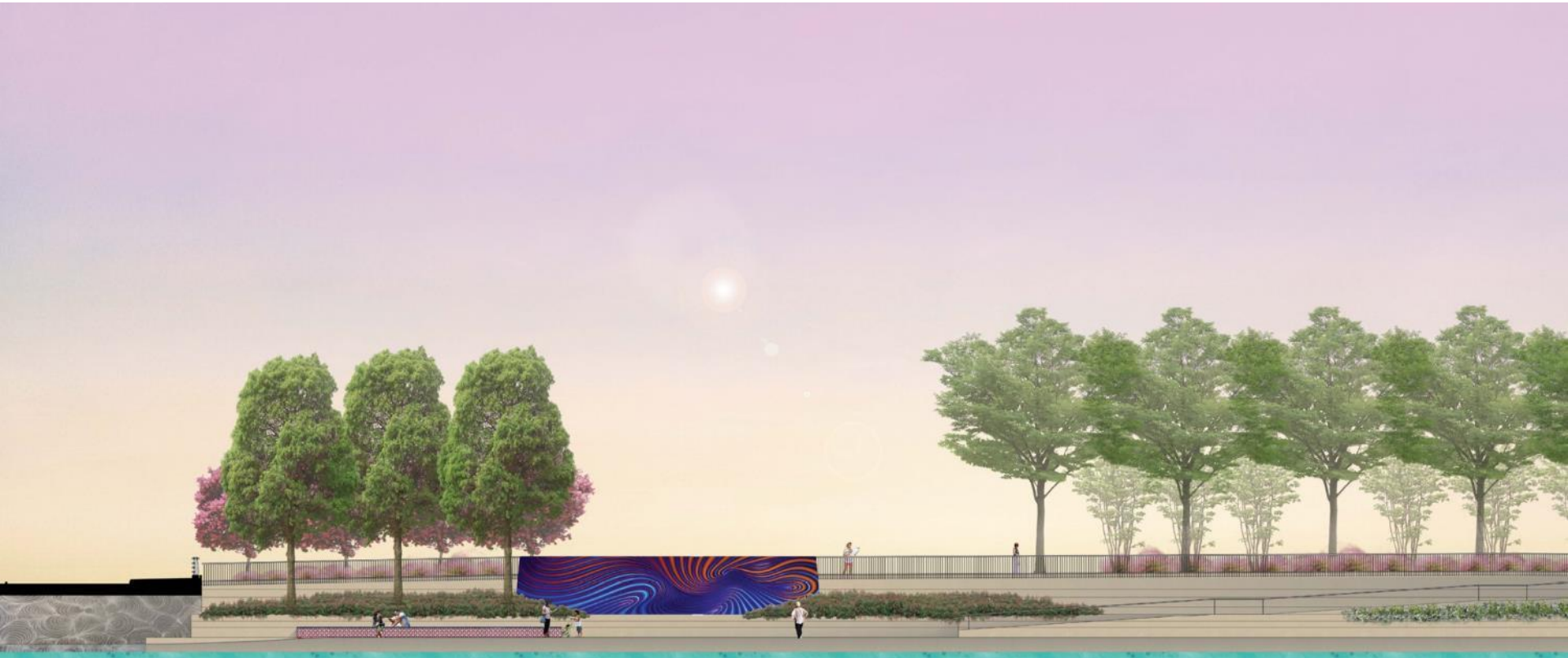

Concept

Painted mural converted to ceramic tile



“The curvilinear line quality will depict flowing water in variations of blue tones with an accent of aqua blue and white.”



JOE LOPEZ

San Antonio, TX

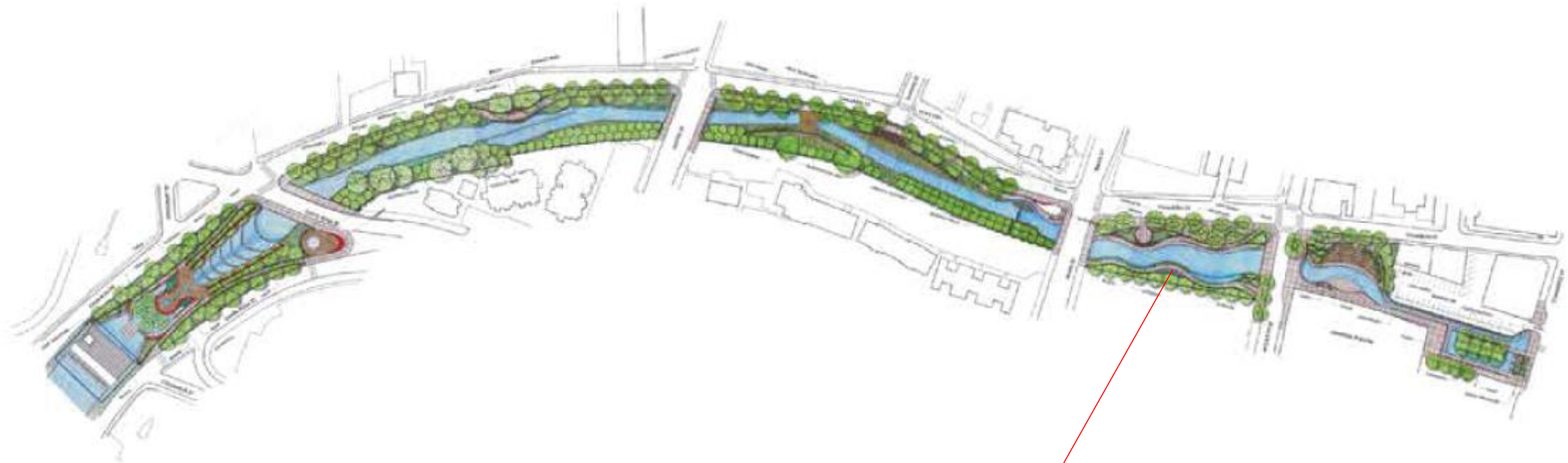

West Bank between Travis Street and Houston Street



Theme: Alameda Theater Community

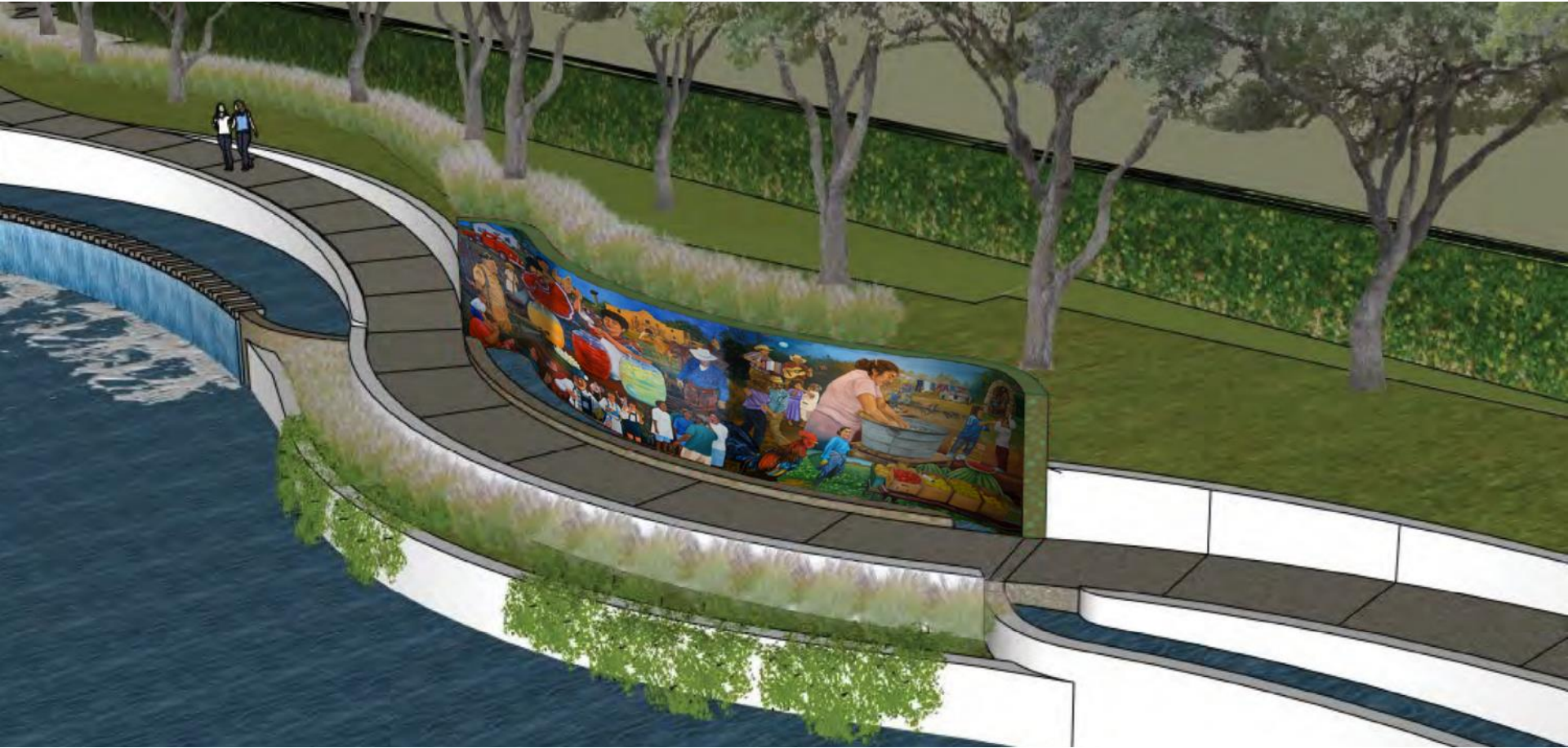

Concept

Painted mural converted to ceramic tile



“My work captures the vibrant community that once enlivened the Alameda Theater. The work depicts the ‘El Carazon,’ the heart of downtown San Antonio. The Alameda was an escape from the harsh reality of life.”



PRE-QUALIFIED LIST OF ARTISTS

- Deadline: June 30, 2017
- Applications via www.PublicArtist.org
- Artwork Opportunities (permanent and temporary):
 - Large-scale murals
 - Light or sound based artwork
 - Integrated or functional artwork on bridges and pathways
 - Large and small-scale sculpture in landscape areas
 - Building facades adjacent to the creek
 - Interactive or performance-based artwork
 - Digital projections at bridge underpasses
 - Serving on a design team for future phases of the project



ARTS & CULTURE ALLIANCE



The San Pedro Creek Arts & Alliance is a collaboration of local arts organizations and artists who are interested in the development of cultural opportunities along the creek



QUESTIONS?

Westside Creeks



City of San Antonio



SAN ANTONIO
RIVER AUTHORITY
Leaders in Watershed Solutions



Linear Creekway Trails Project and Elmendorf Lake Park

Dustin Moore

June 20, 2017

Elmendorf Lake Park

- All punch list items have been completed by contractor and the park has been turned over to CoSA Parks and Recreation Dept.
- Park is currently under a warranty period until January 2018.



City of San Antonio



SAN ANTONIO
RIVER AUTHORITY
Leaders in Watershed Solutions



ARCADIS

The Water Division of ARCADIS



Westside Creeks
Pescapacion Project

Trail Projects (Sales Tax Initiative)

Schedule

- Alazan Creek (RESPEC)-Design in progress and 40% Review & Public Meeting anticipated in November 2017.
- Martinez/Zarzamora Creek (Pape-Dawson)-Design in progress and 40% Review & Public Meeting anticipated in November 2017.
- Anticipate design & permitting complete by December 2018.
- Anticipate construction start in January 2019 & complete in December 2019.



City of San Antonio



Alamo Area MPO Grant

- Alazan Creek was selected and recommended for funding.
- Recommended award was for \$2,500,000 for Alazan Creek.
- Will award at June 26, 2017 meeting.
- Additional funds will be utilized for amenities and beautification along the proposed trail.

